

Maat A

70,00mm

6,00mm

33,0mm

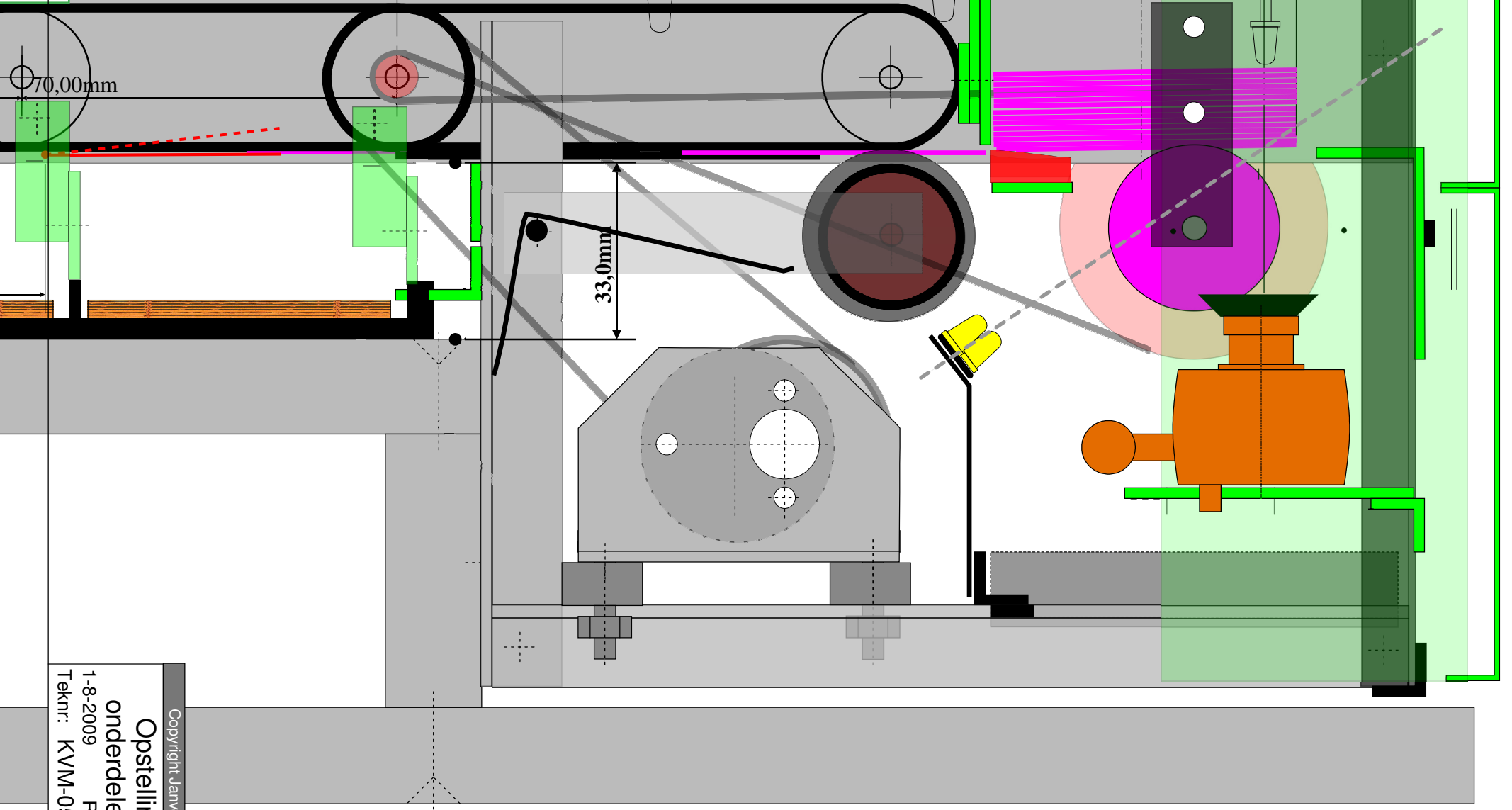

Copyright JanvdVen
Opstelling
onderdelen 1
1-8-2009 Rev:
Teknr: KVM-05

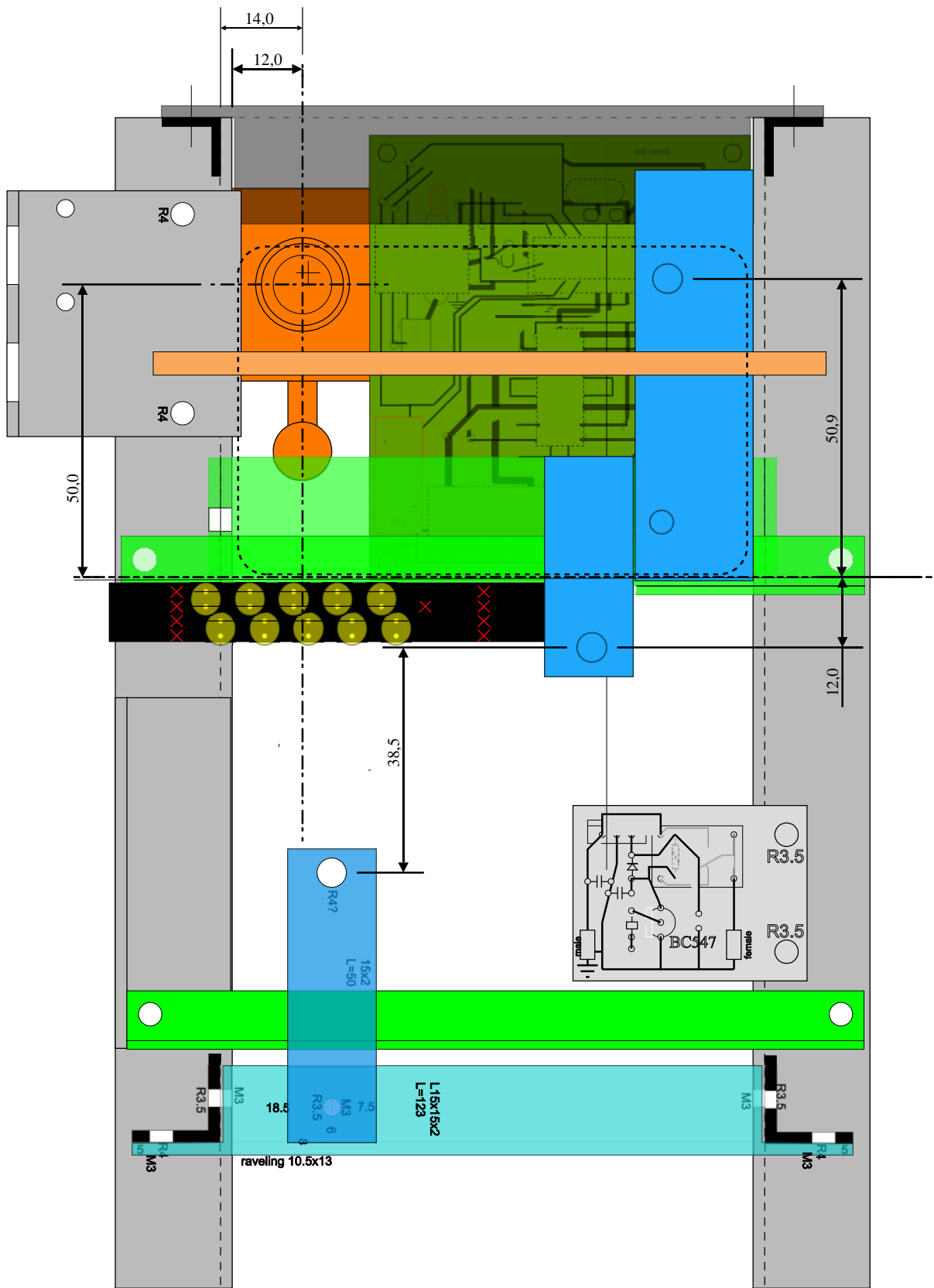

Copyright JanvdVen

Opstelling onderdelen 2

1-8-2009 Rev:
Teknr: KVM-06

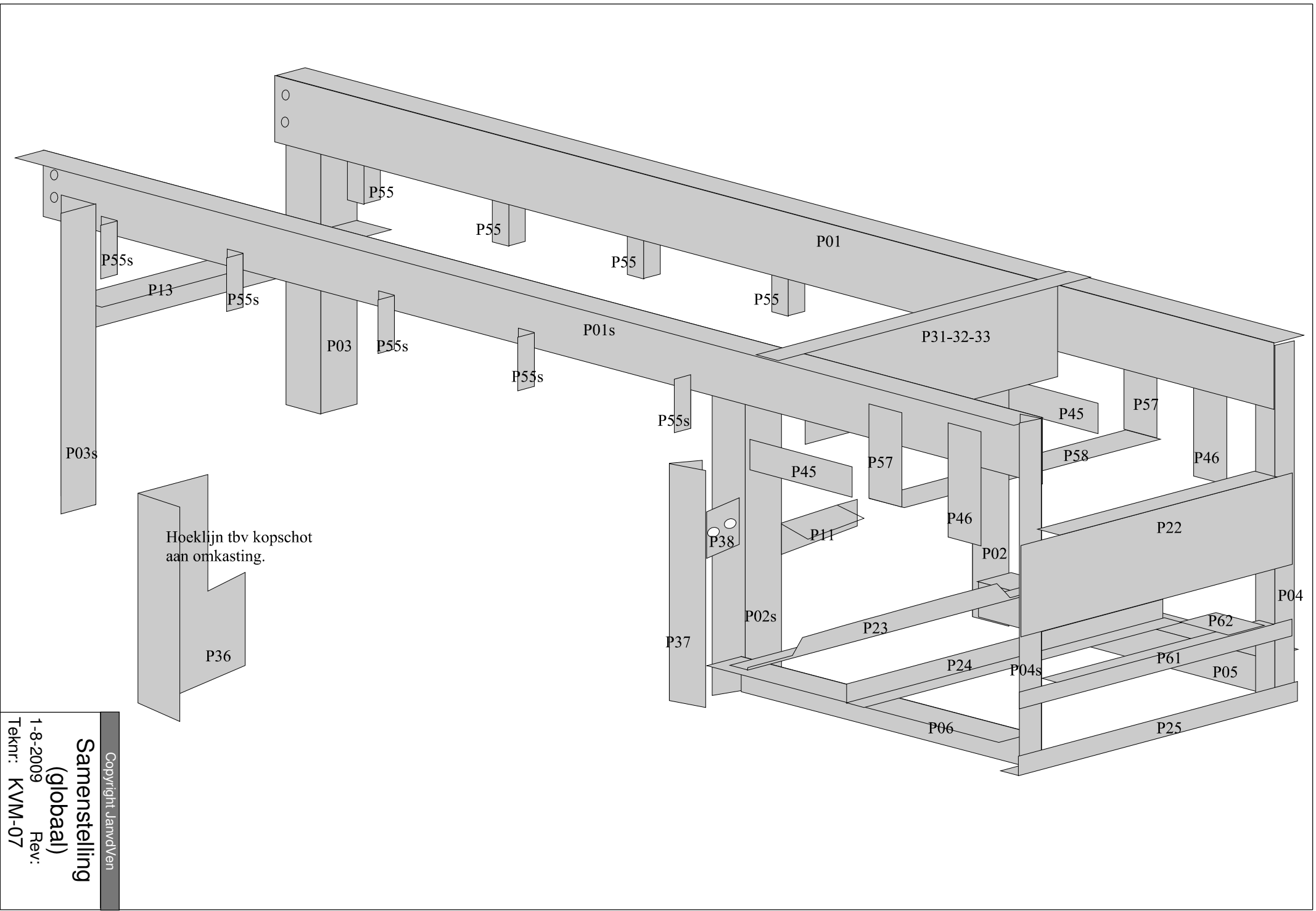

Copyright JanvdVen
Samenstelling
 (globaal)
 1-8-2009 Rev:
 Teknr: KVM-07

Hoeklijn tbv kopschot
 aan omkasting.

P36

P55s

P13

P55s

P03

P55s

P01s

P55s

P55s

P03s

P55

P55

P55

P55

P01

P31-32-33

P45

P57

P58

P46

P45

P57

P46

P02

P22

P38

P11

P04

P02s

P23

P62

P37

P24

P04s

P61

P05

P06

P25

P01
Alu L40x20x2
1x L=487.5

P01s
Alu L40x20x2
1x L=487.5

P01s is het spiegelbeeld van P01

P01: alle WITTE en ZWARTE gaten boren.
P01s: alleen alle WITTE gaten (doorboren)

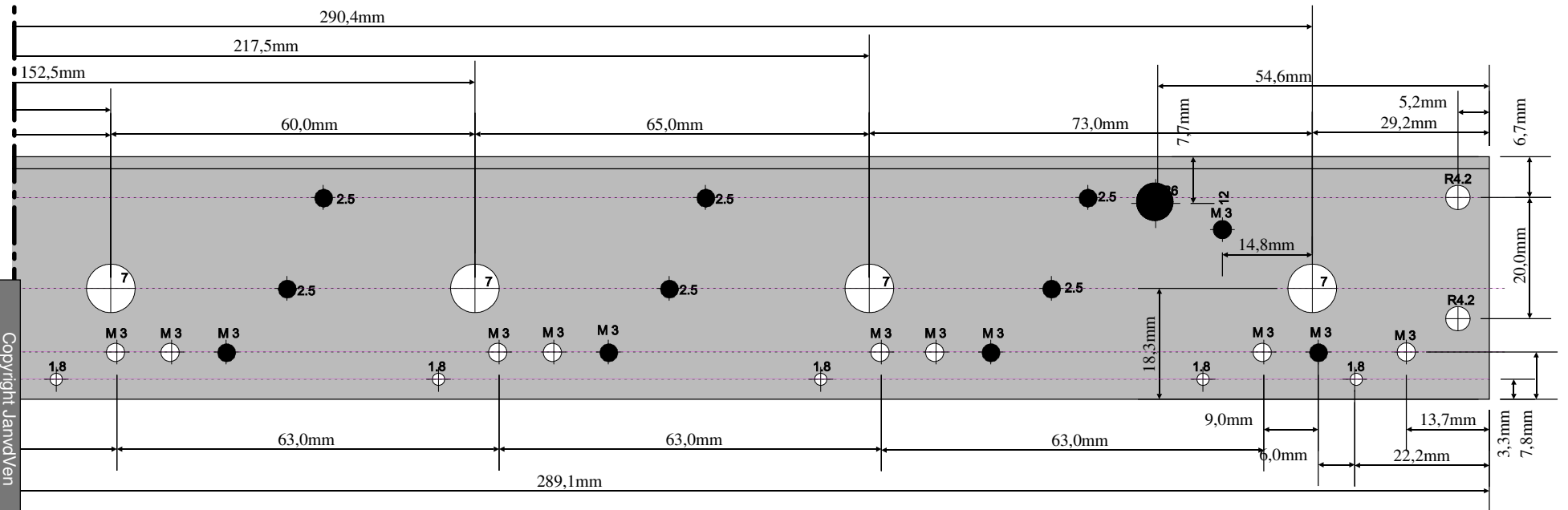
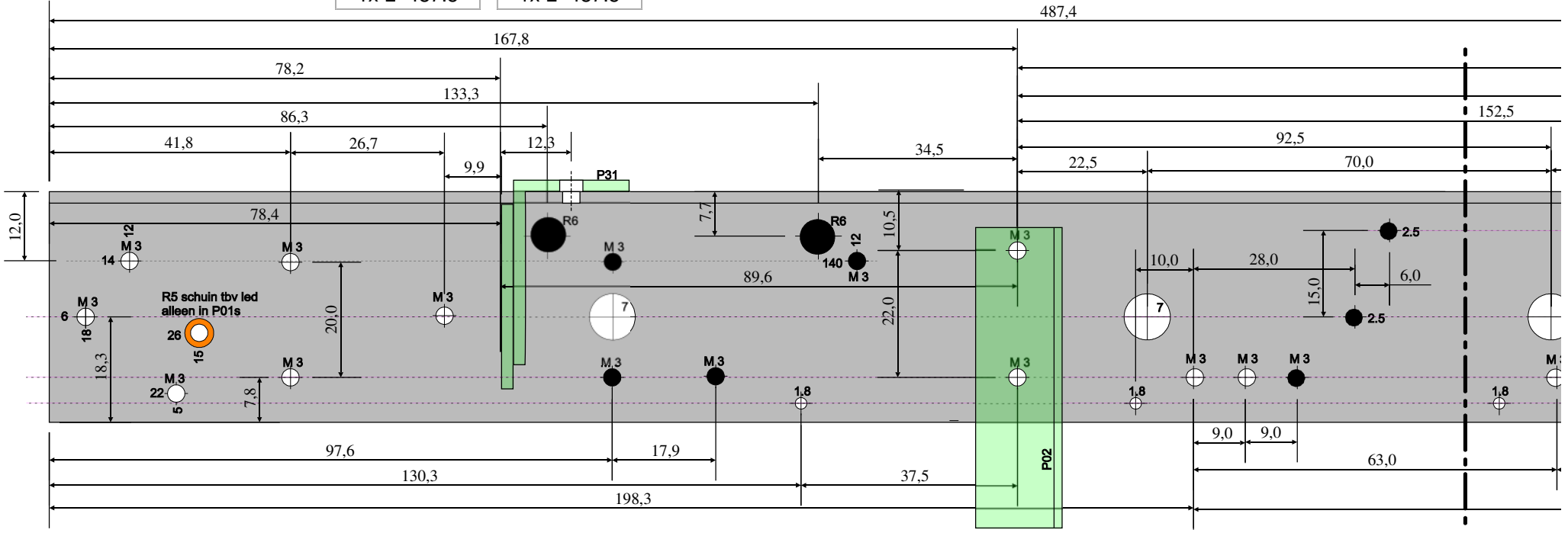

1-8-2009 Rev:
Teknr.: KVM-11

Hoofdbeam
Copyright JanvdVen

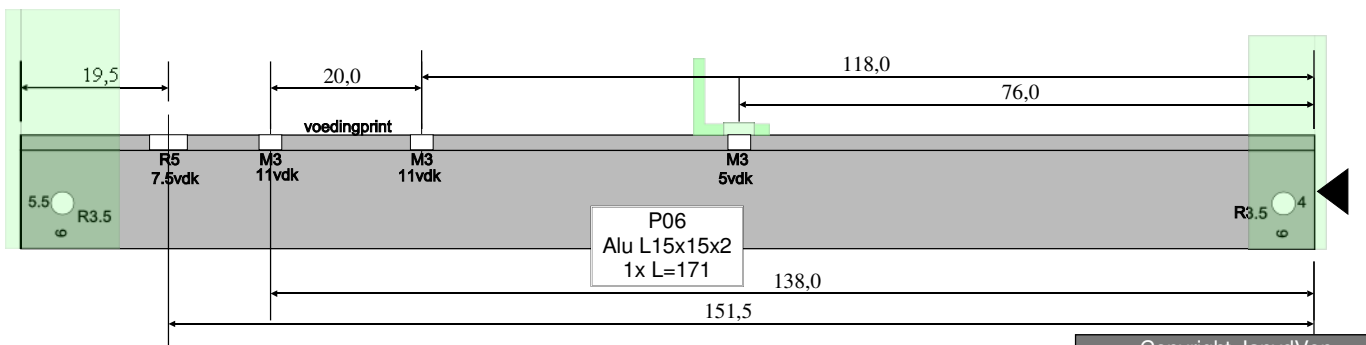
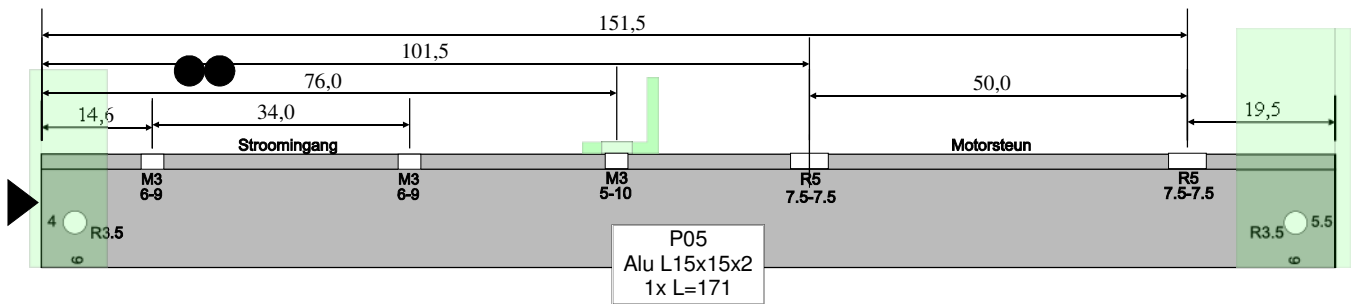
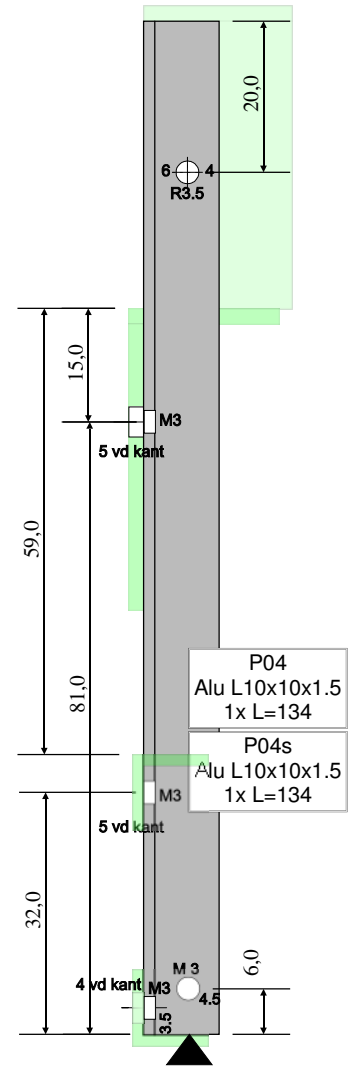
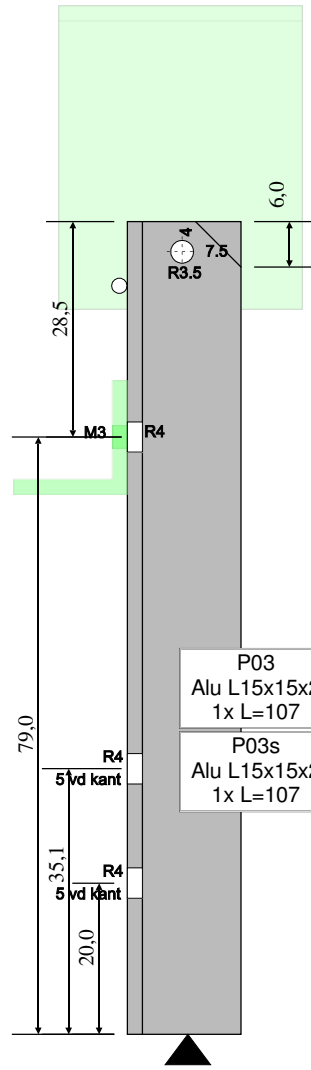
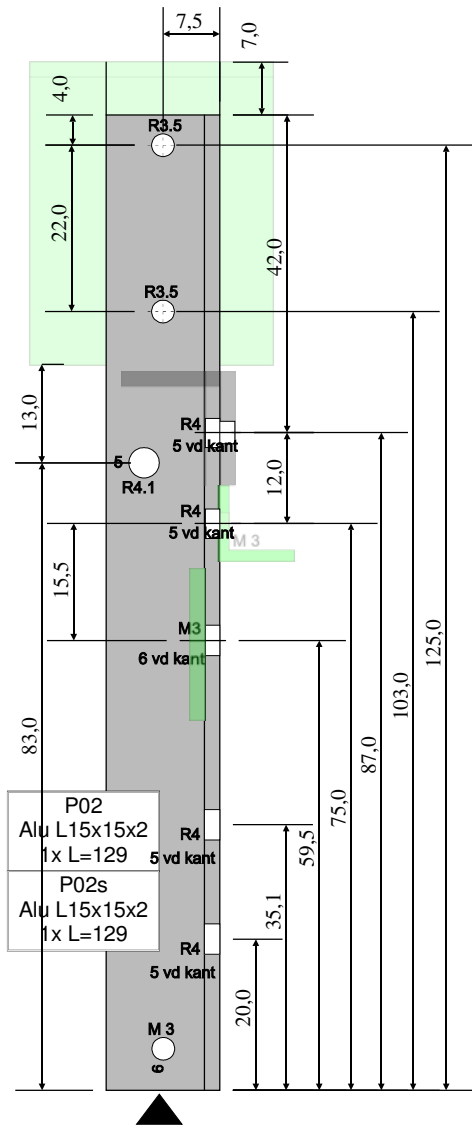

Copyright JanvdVen

Frames

1-8-2009 Rev:
Teknr: KVM-13

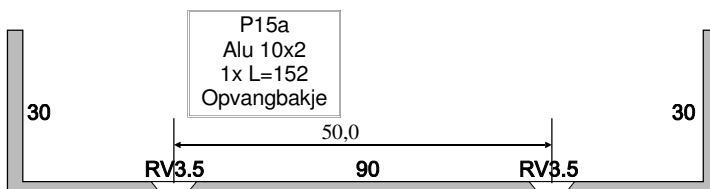
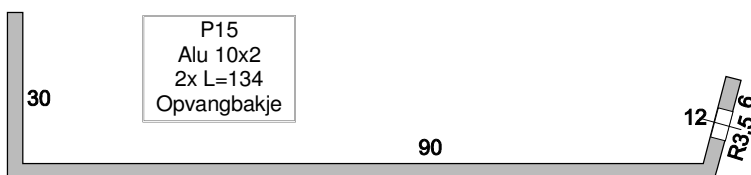
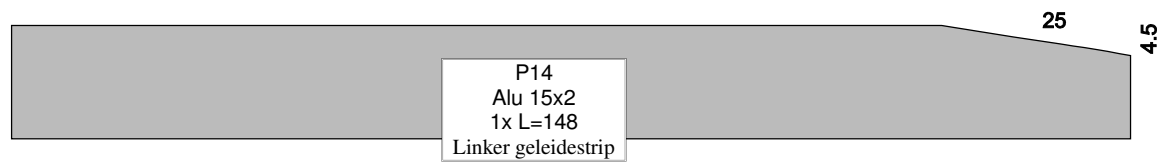
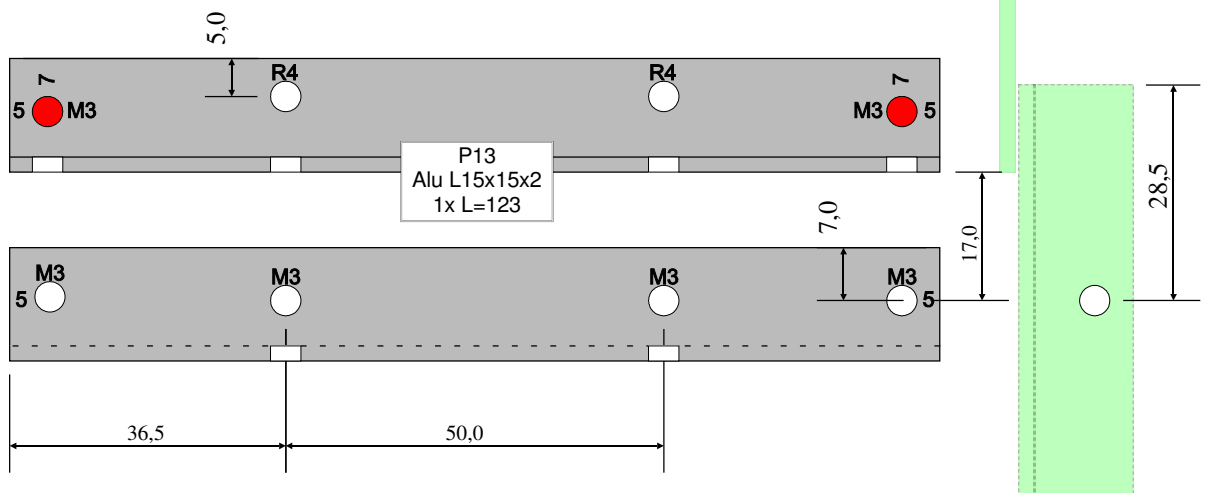
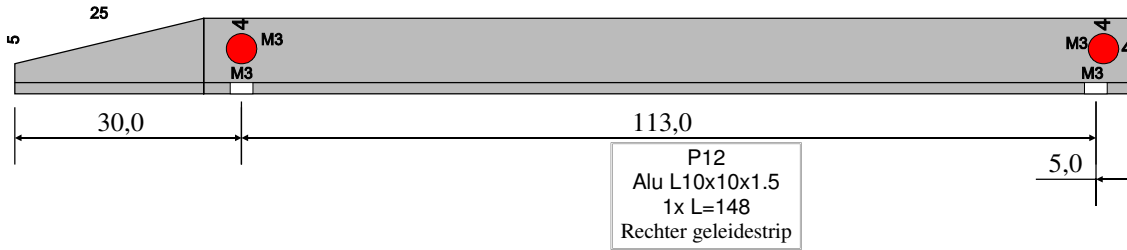
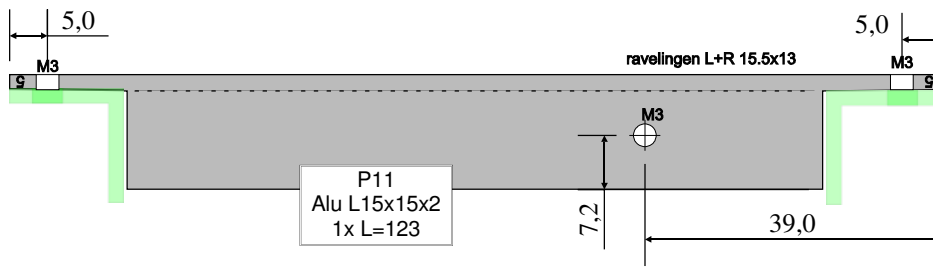

Copyright JanvdVen

Geleiders ed

1-8-2009 Rev:
Teknr: KVM-14

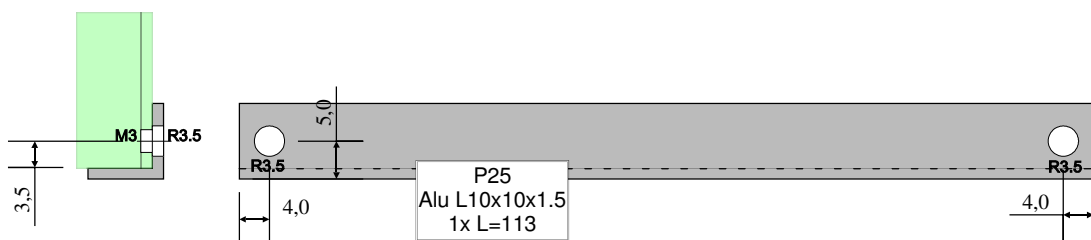
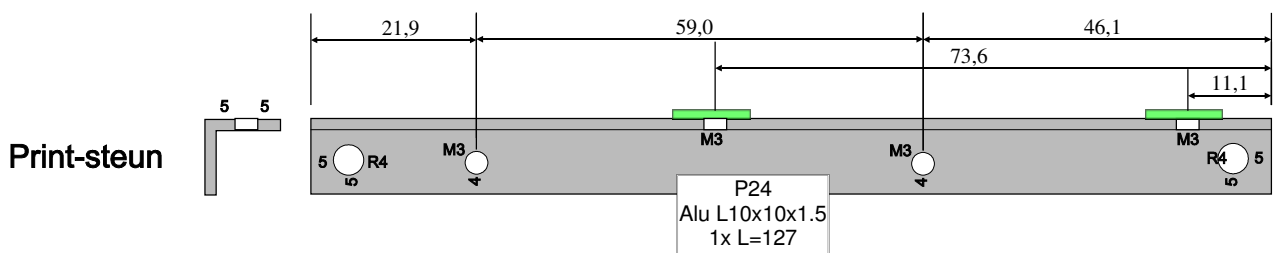
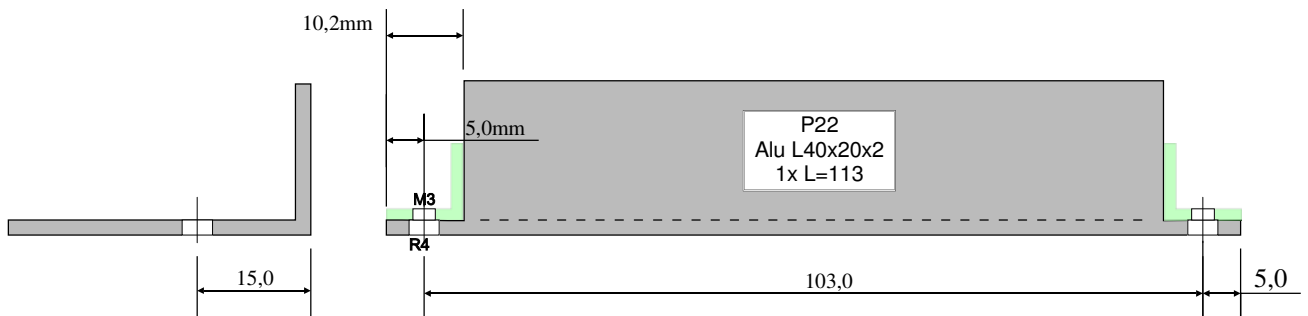
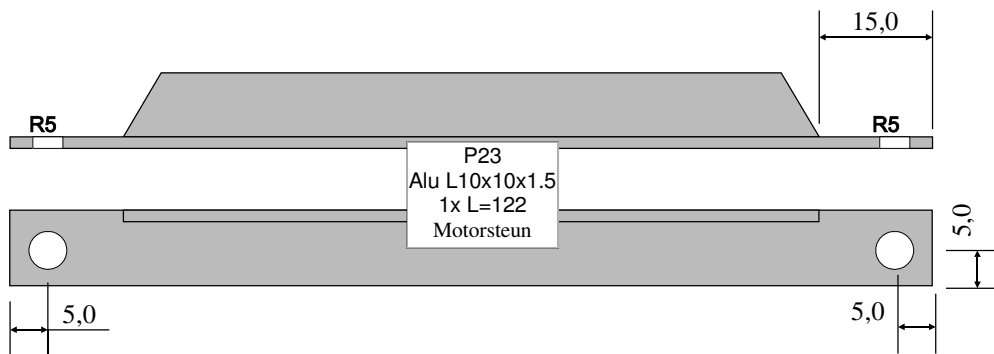
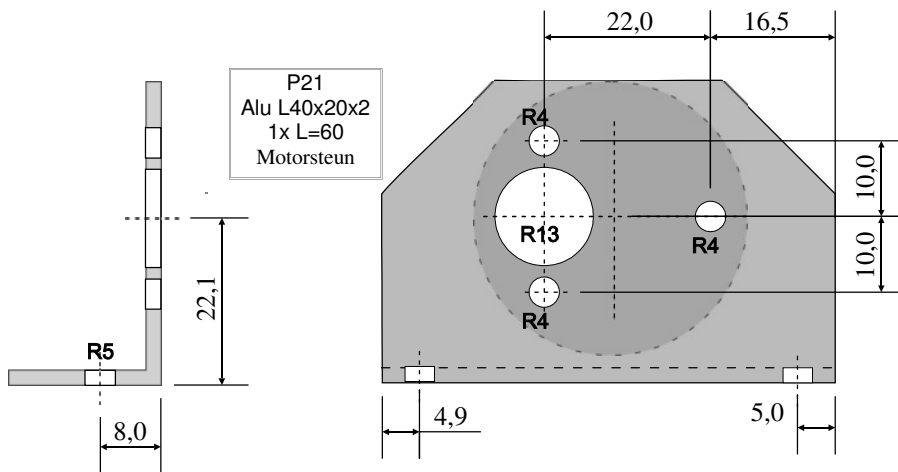

Copyright JanvdVen

Motor- printsteun
en einden

1-8-2009 Rev:

Teknr: KVM-15

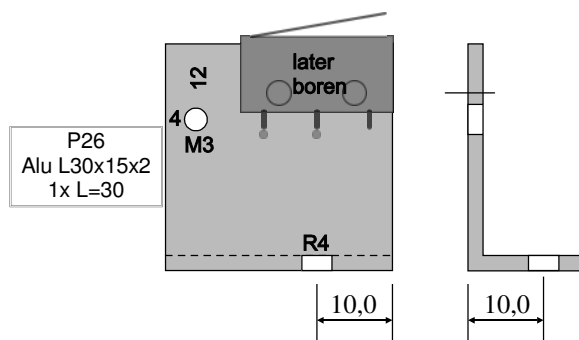
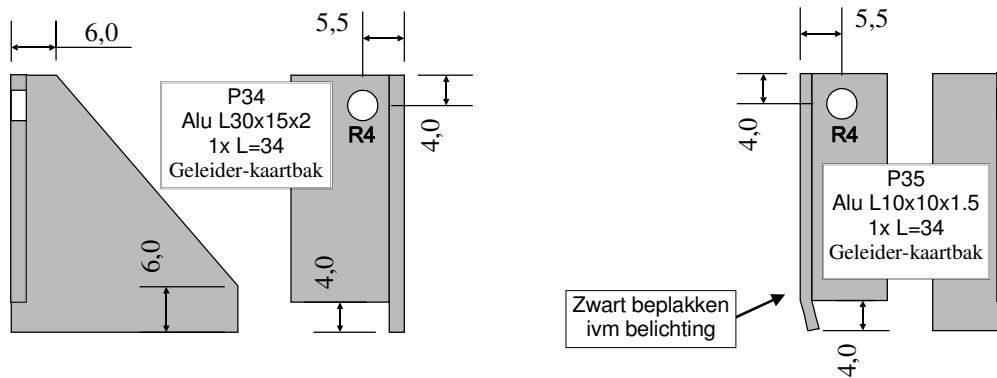
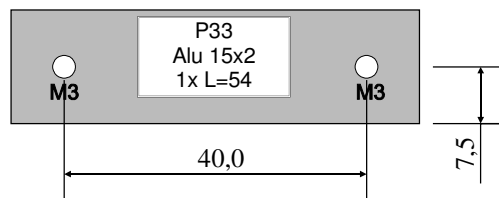
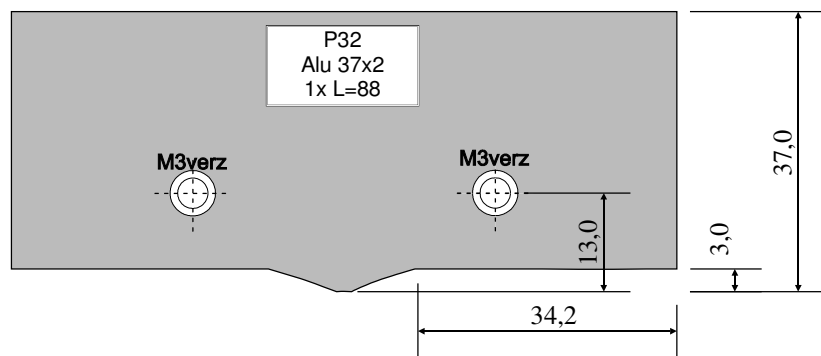
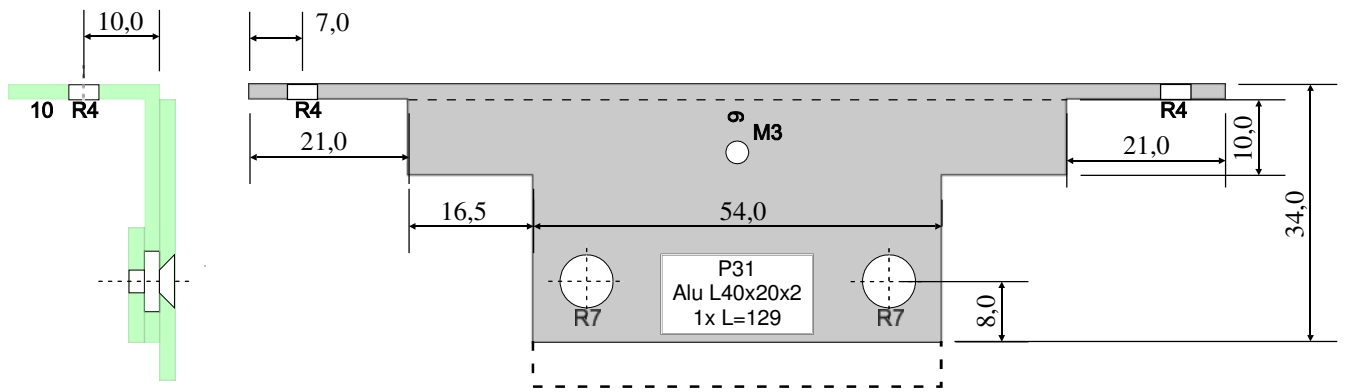

Copyright JanvdVen

Kaartbak

1-8-2009 Rev:
Teknr: KVM-16

Linker

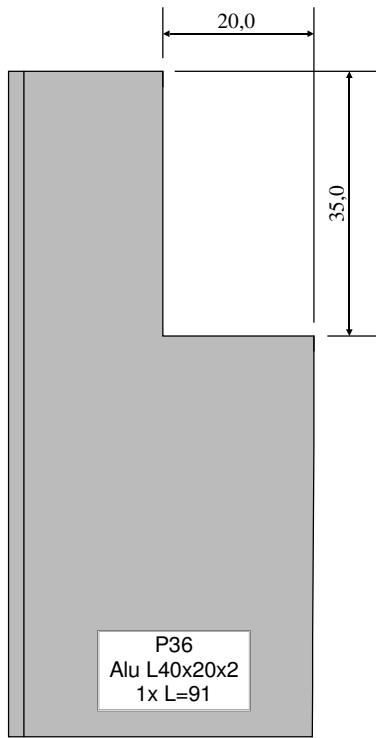

Rechter

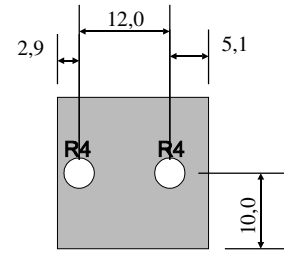
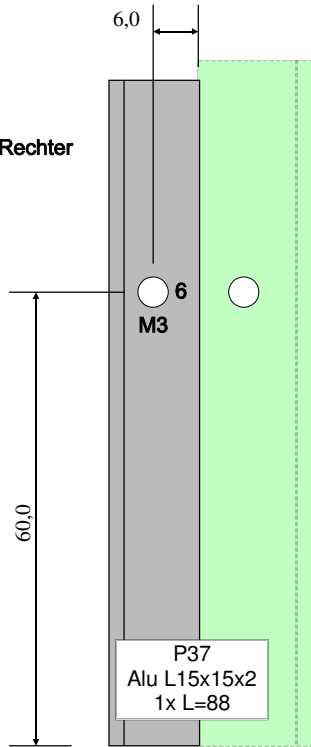

P38
Alu 20x2
1x L=20

12 Afzagen tot 12mm

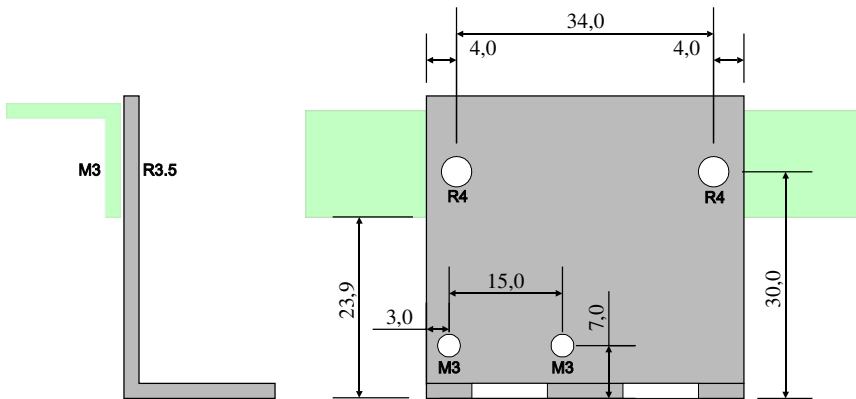

P39a
PVC 20x2
1x L=10

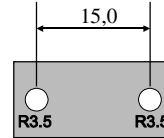

P39
Alu L40x20x2
1x L=42

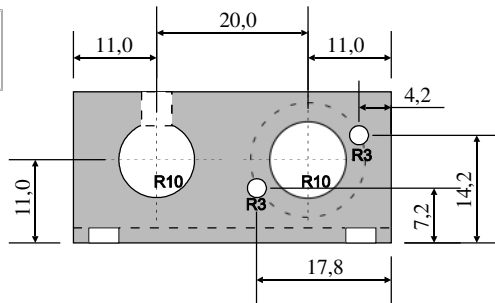

P39b
1x L=10

1x rubber dik 4
1x pvc dik 4



Copyright JanvdVen

**Kopschotjes
en stroomgang**

1-8-2009 Rev:

Teknr: KVM-17

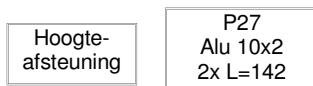
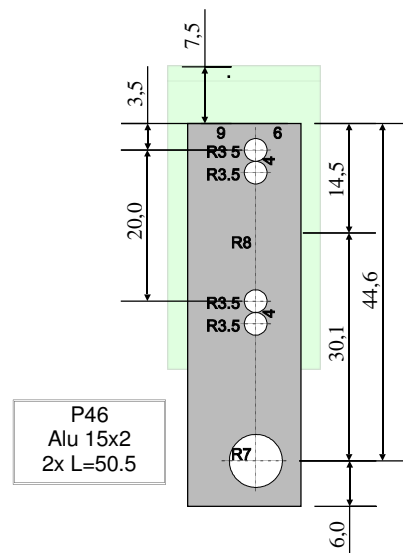
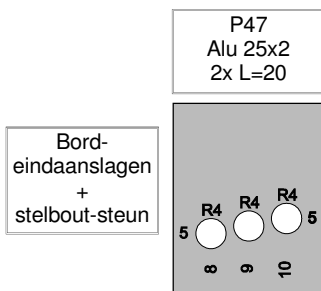
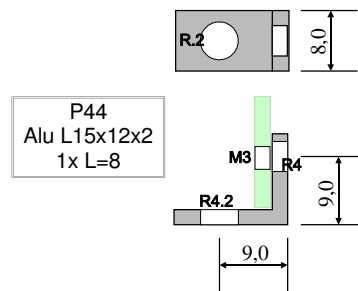
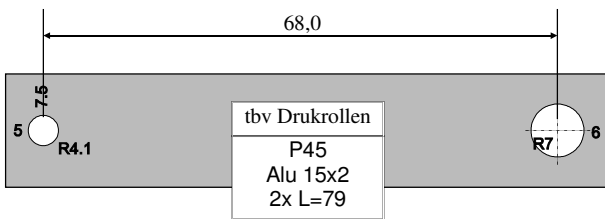
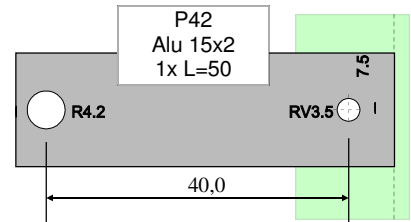
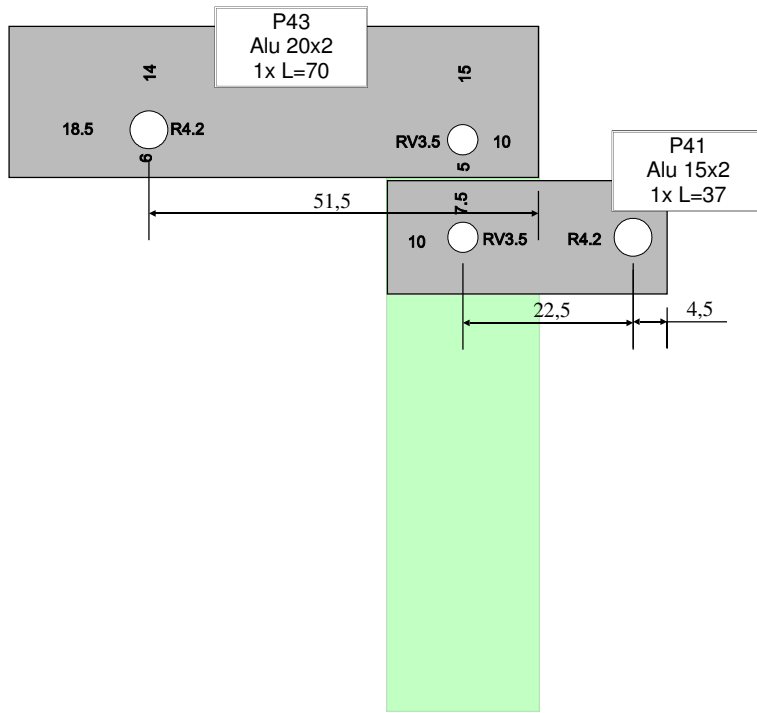

P51
Alu Buis R4-R6
2x L=89
Afstandhouders

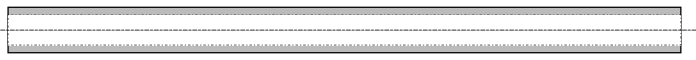

P52
Alu Buis R4-R6
1x L=20
Kaartsluis

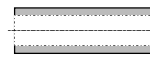

P53
Draadeind M4
2x L=101

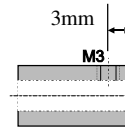

Kunststof
Buis R4-R8
1x L=15
Aandrijving

P54
Alu L10x10x1.5
4x L=22

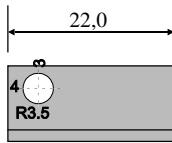

P55
Alu L10x10x1.5
5x L=26,5

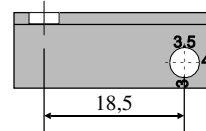

P55s
Alu L10x10x1.5
5x L=26,5

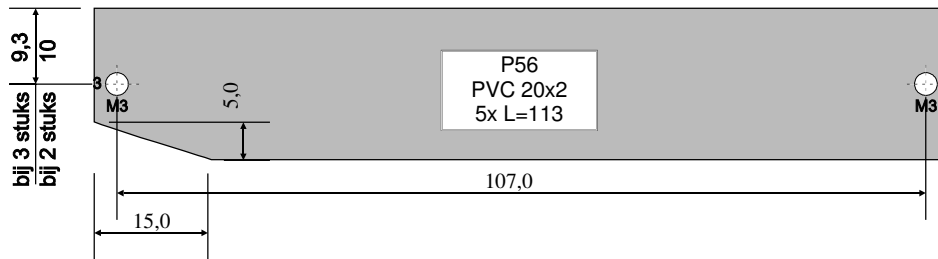
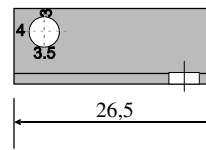

P57
Alu L30x15x2
2x L=20

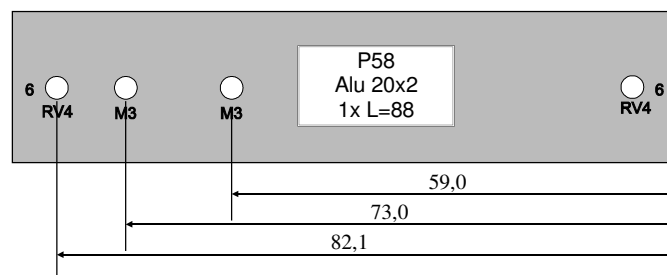
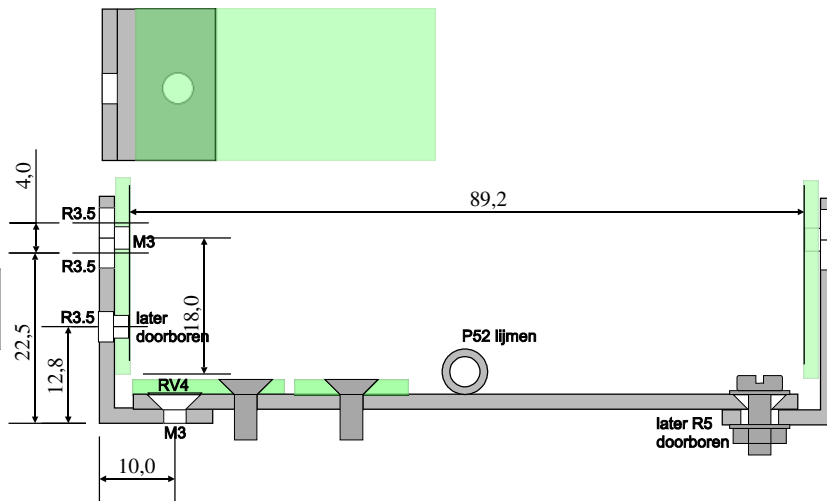

Copyright JanvdVen

Afstandhouders ed

1-8-2009 Rev:
Teknr: KVM-19

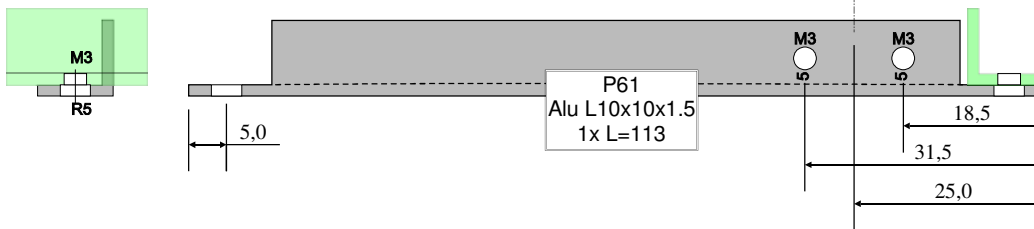

Geschikt voor camera's:
- pc camera 268

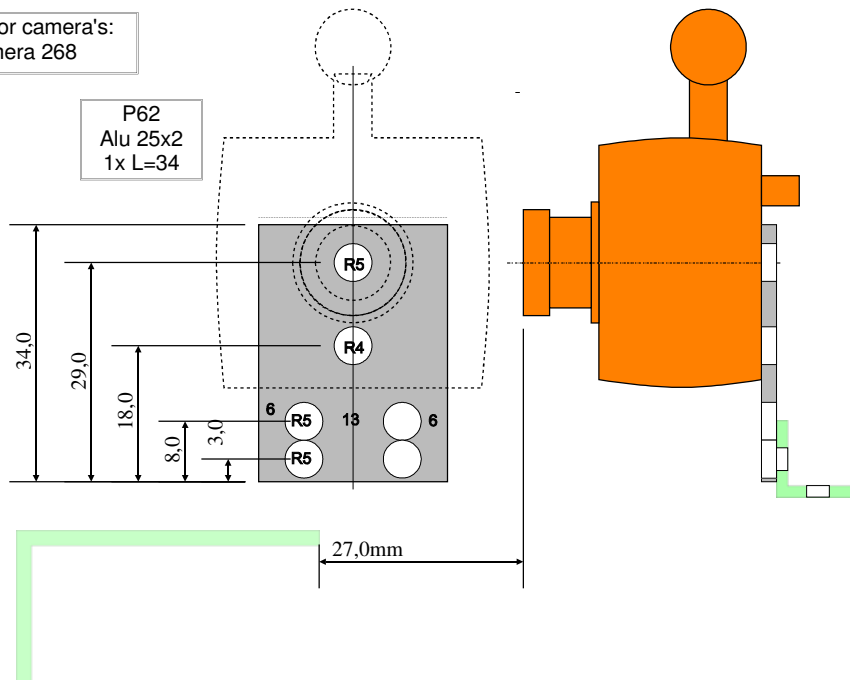

Materiaal: Aluminium plaat dik 1mm

Maten in mm (inwendig)

Oppervlaktebehandeling: onbewerkt

- - - - = zichtzijde

Strepen in de lengterichting

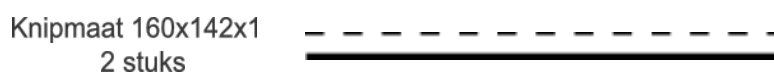
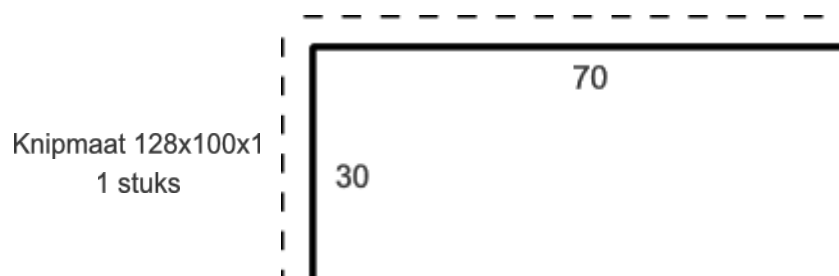
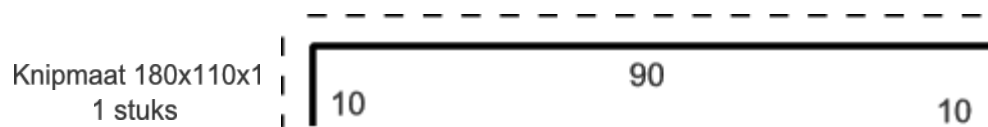
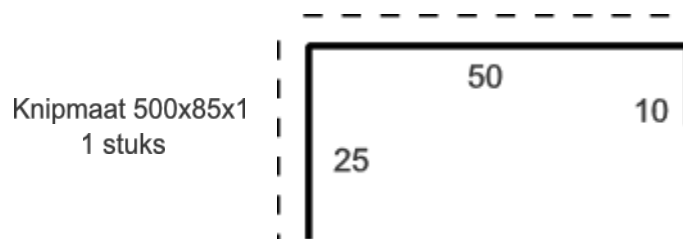
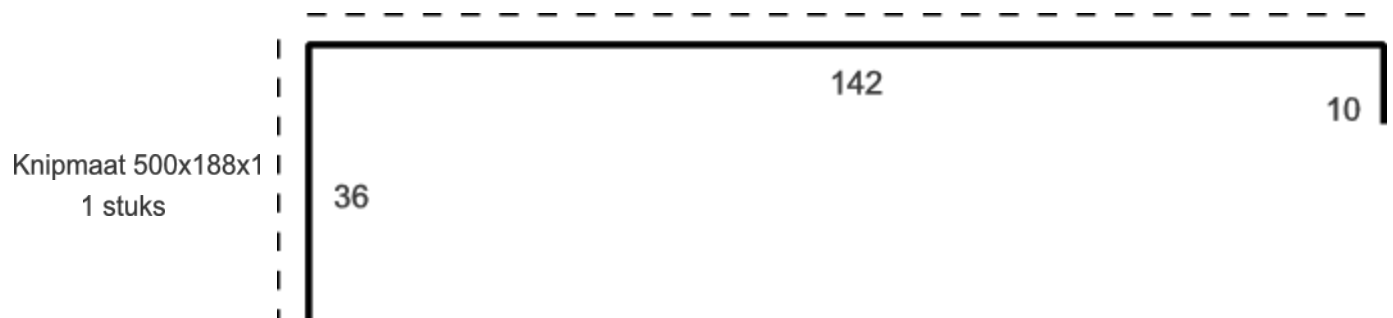

Copyright JanvdVen

Omkasting

1-8-2009 Rev:

Teknr: KVM-61

Materiaal: Aluminium plaat dik 1mm

Alle gaten rond 3.5 (tbv M3)

Alle zettingen naar achteren.

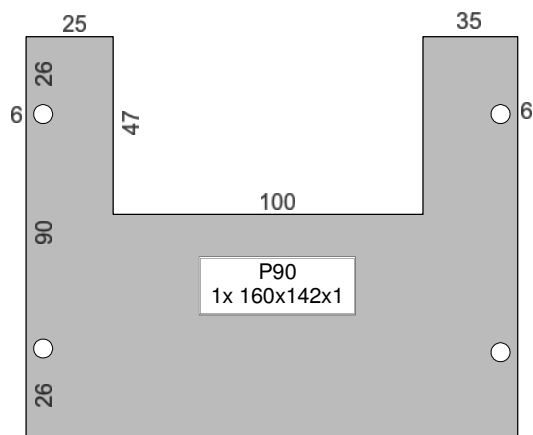
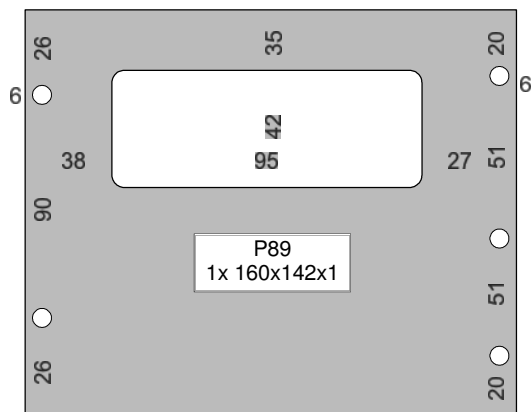
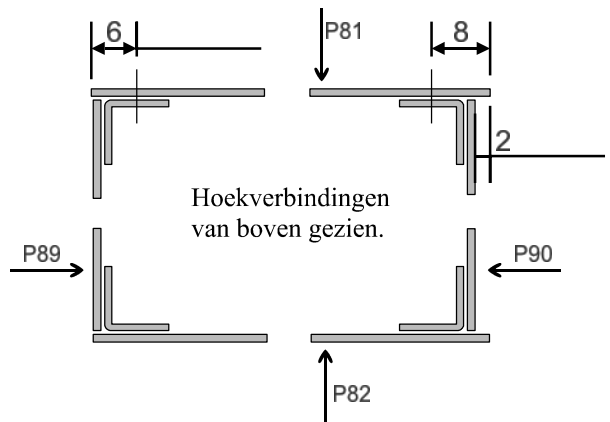
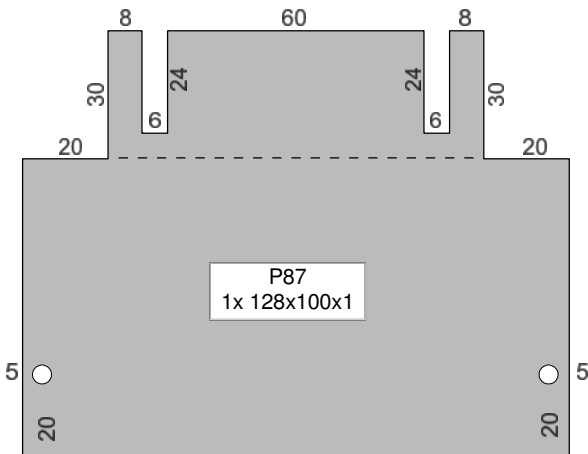
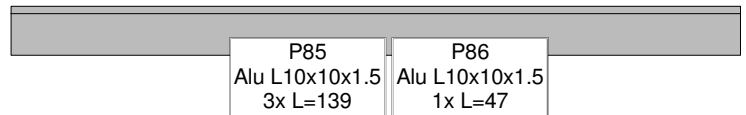
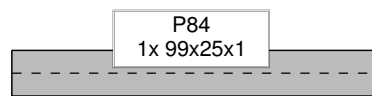
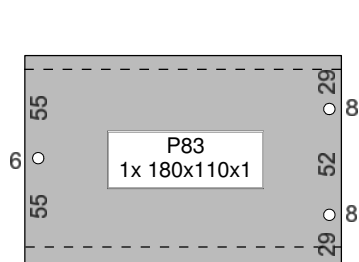
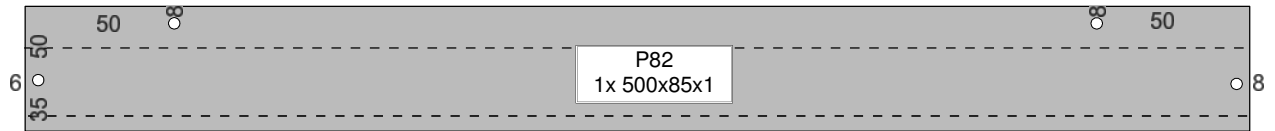
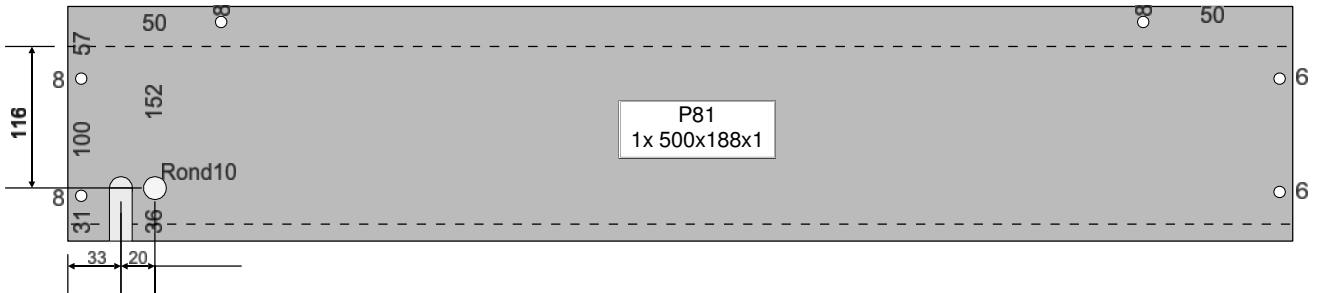

Copyright JanvdVen

**Omkastings
uitslagen**

1-8-2009 Rev:

Teknr: KVM-62

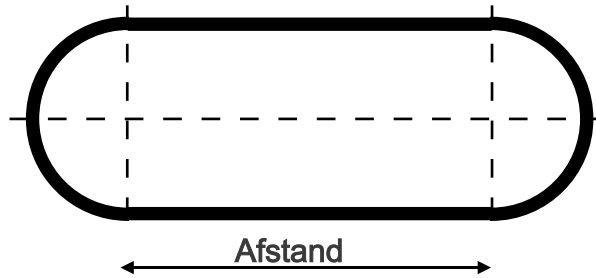

Transportriempjes kunnen worden geleverd uit een stuk.

Materiaal: Rubber			
Riembdikte 3mm			
Nr	Afstand	Lengte	Aantal
1	138	353	2x
2	130	337	2x
3	93	263	2x
4	0	72	4x
motorriem			
5	99	284	1x
Riembdikte 2mm			
6	151	381	1x

Bestelmaten bij www.technirub.nl: Kwaliteit: NBR 70shore	
108 x 3	2x
103 x 3	2x
79 x 3	2x
87 x 3	1x
120 x 2	1x

<u>Asjes</u>	
Materiaal: staal of alum	
Rond 4.0mm (passend in de lagers!!)	
1 stuks L=130mm (sta)	Aandrijfjas
1 stuks L=130mm (sta of alu)	Kaartbak
1 stuks L=115mm (sta)	Lagering
6 stuks L=115mm (alu)	Rest

Copyright JanvdVen

**Aandrijfriemen
Asjes**

1-8-2009 Rev:1-7-2023

Teknr: KVM-71

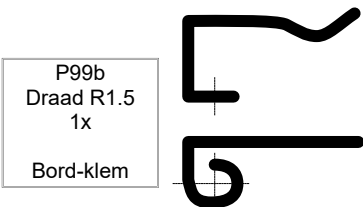
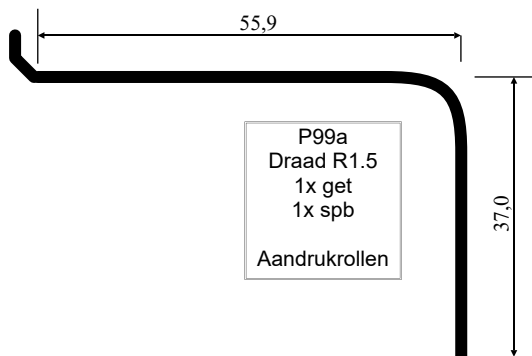
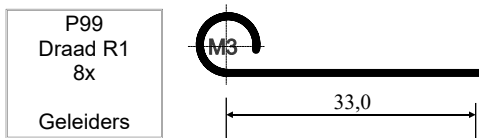
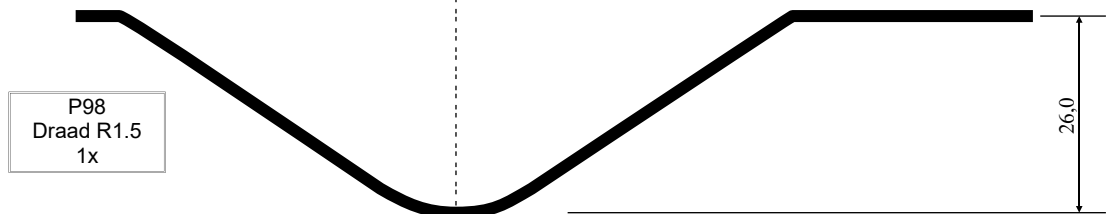
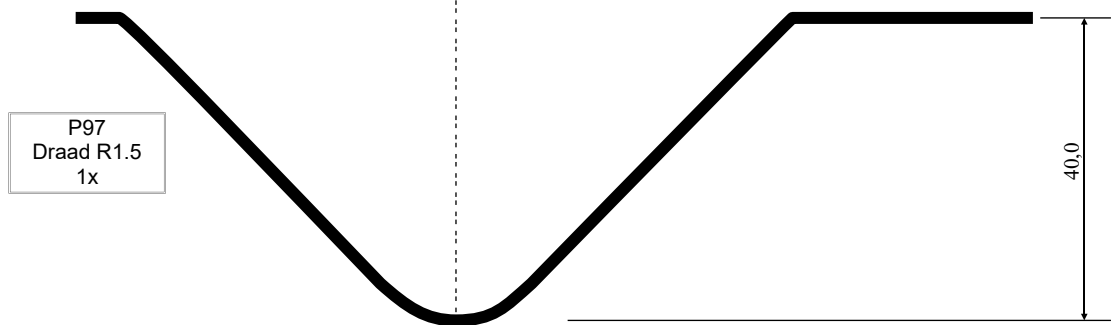
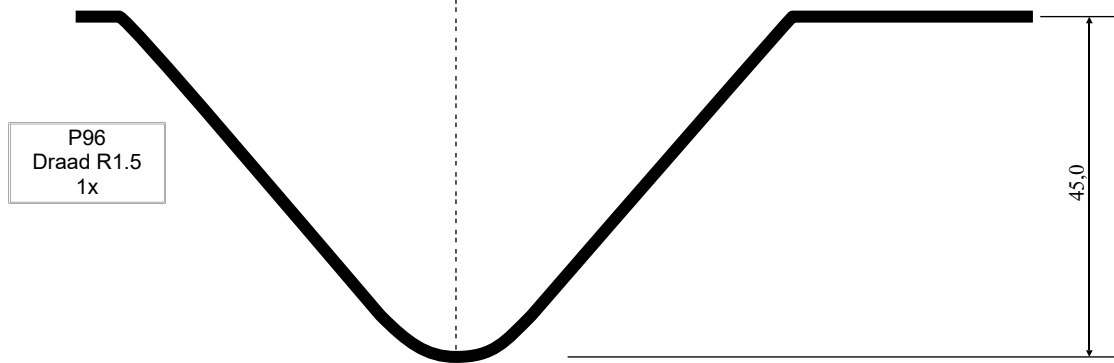
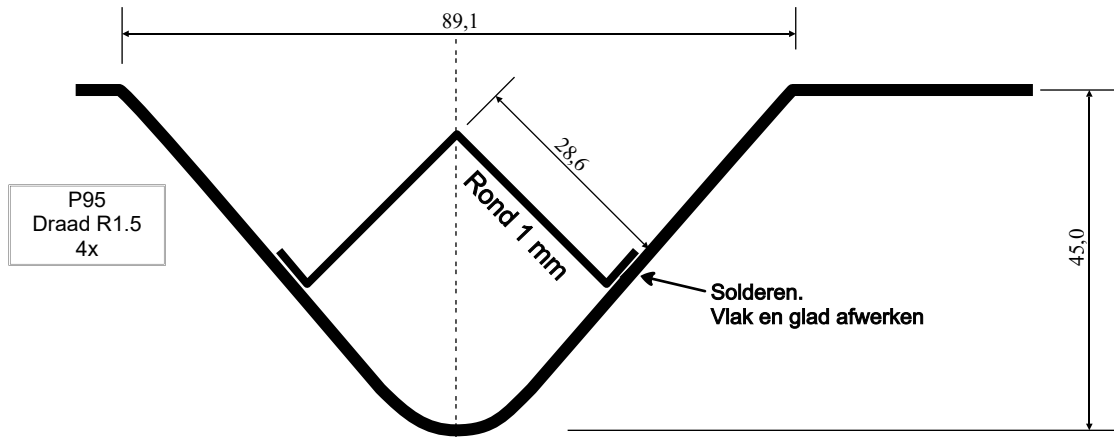

Materiaal: paperclips

Copyright JanvdVen

Draaddelen

1-8-2009 Rev:
Teknr: KVM-72

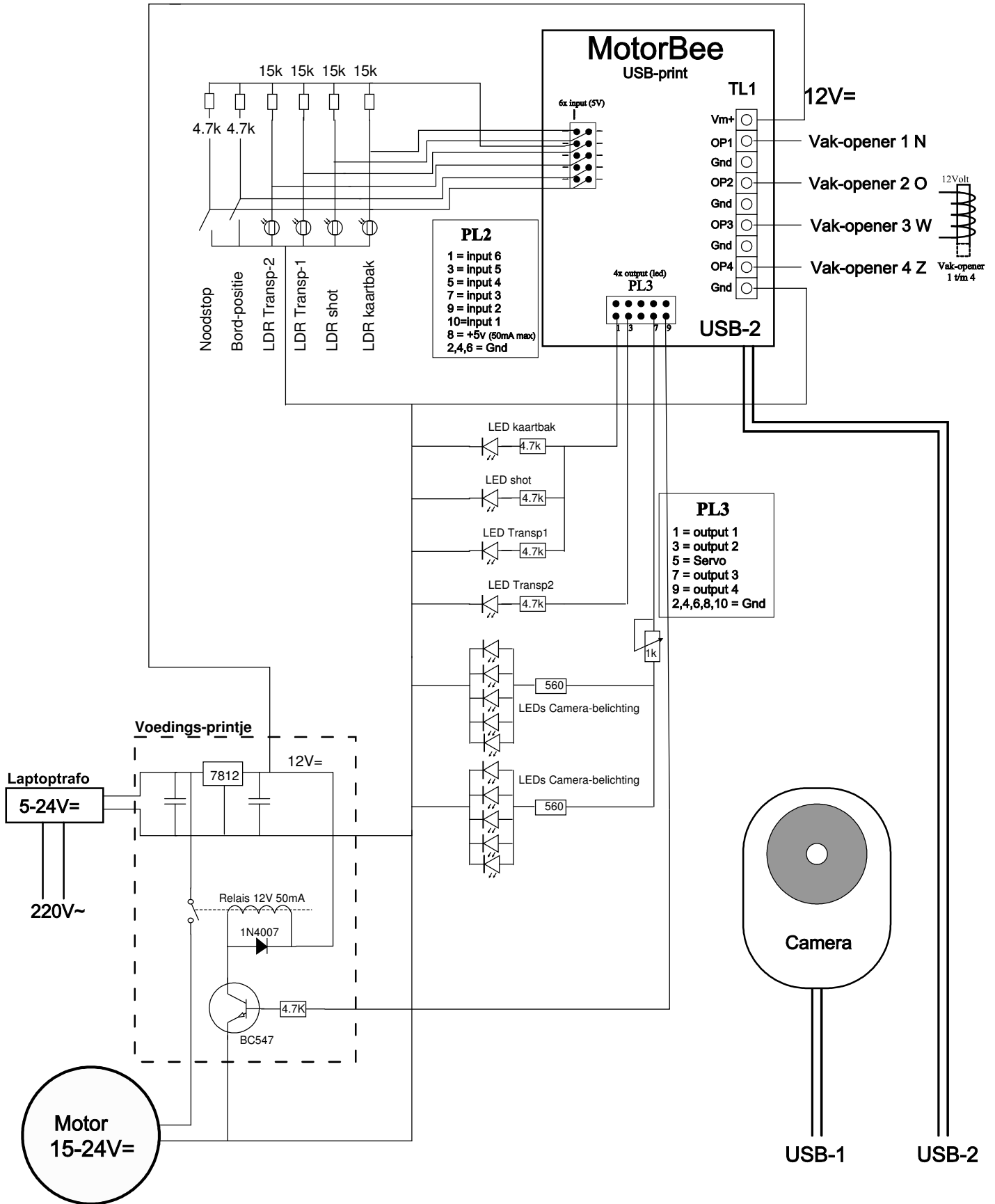

Werkspanning: Bandsnelheid: Tijd per spel:

16 Volt	0.500 m/sec	13.4 sec
15 Volt	0.470 m/sec	14.0 sec
14 Volt	0.440 m/sec	14.6 sec

ca. waarden

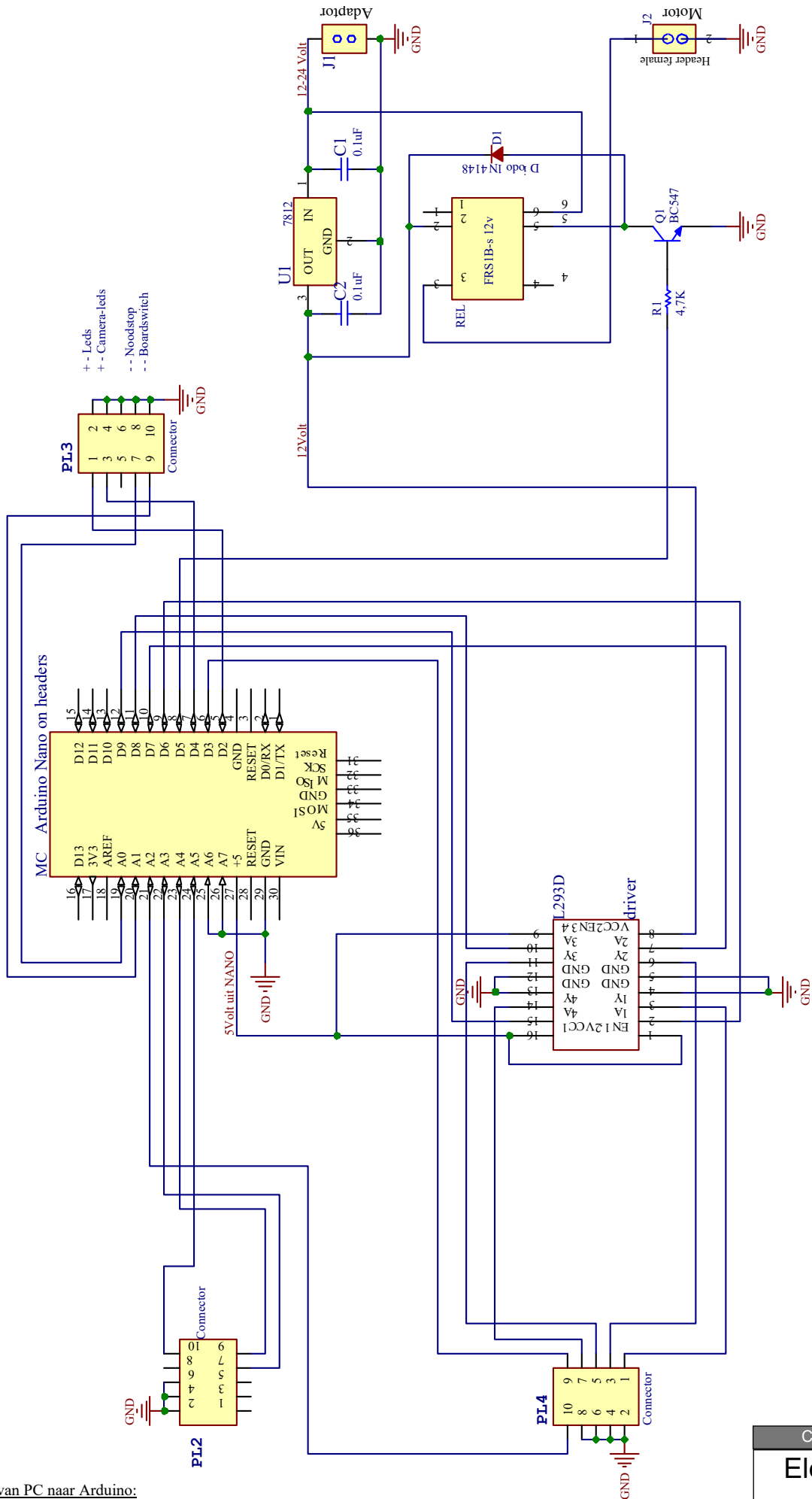

Verbinding van PC naar Arduino:
 Of kabel USB-C voor NANO V3.0
 Of kabel USB-mini voor NANO V3.0 Compatible

Copyright JanvdVen

Elektra-NANO

1-7-2023 Rev:
 Teknr: KVM-91N

Print getekend op 2x de ware grootte
 Print-afmeting: 65x76mm

In rood, groen en blauw:
 Op de print doorverboden bedrading

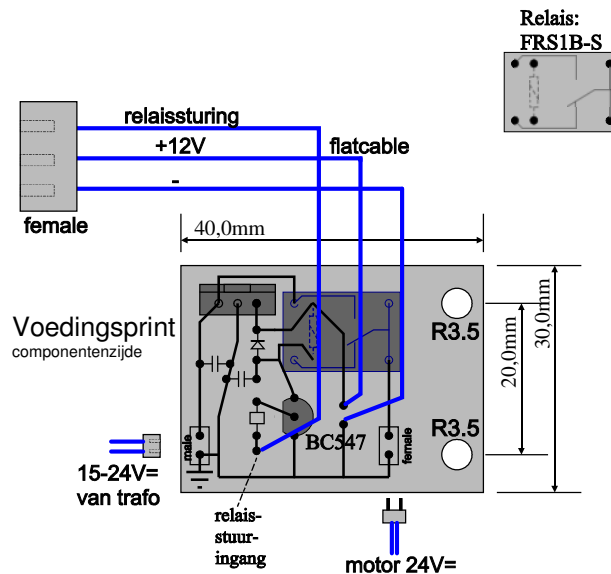
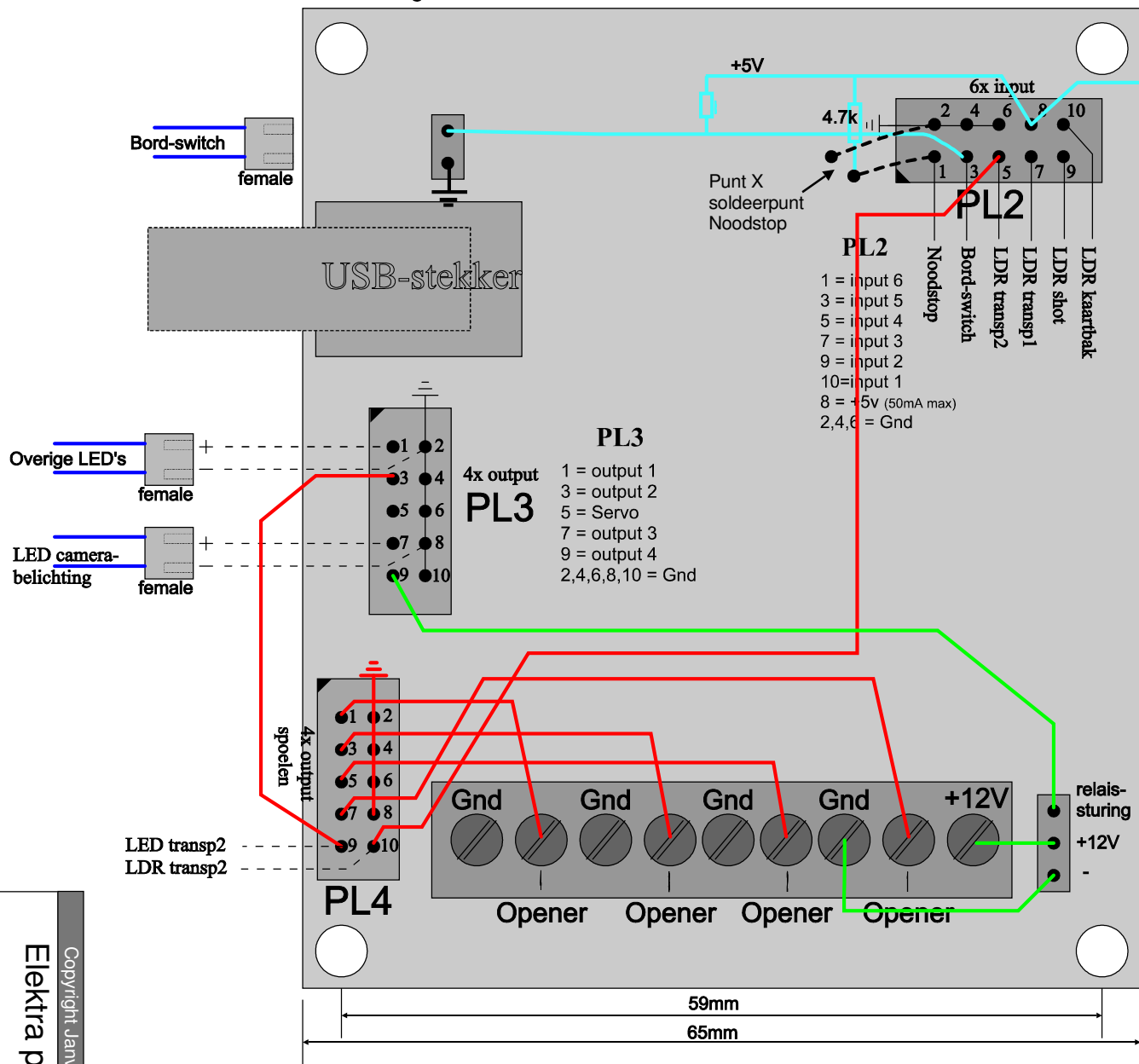

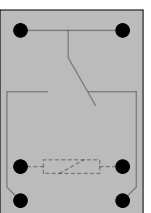
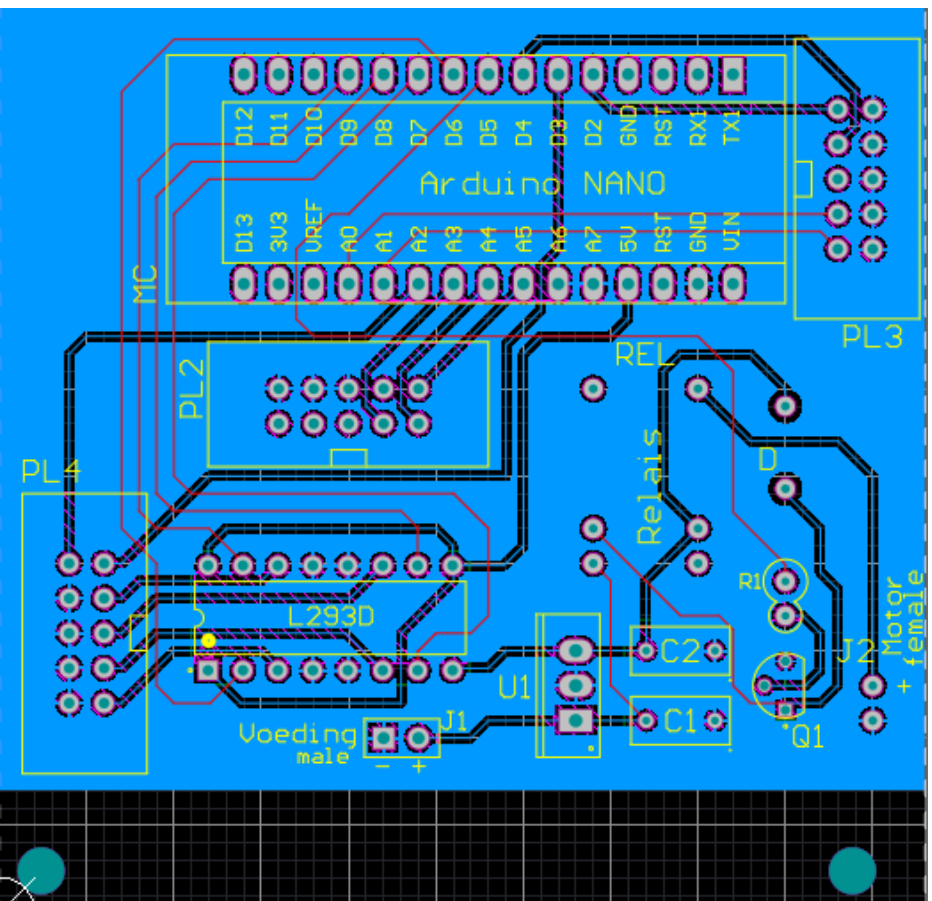
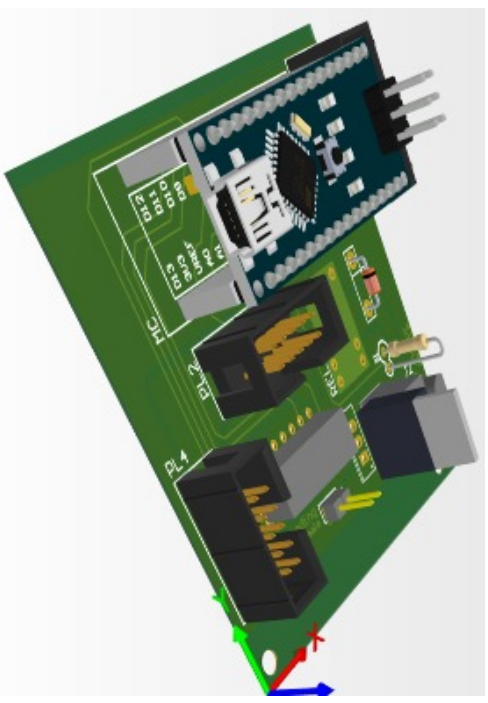
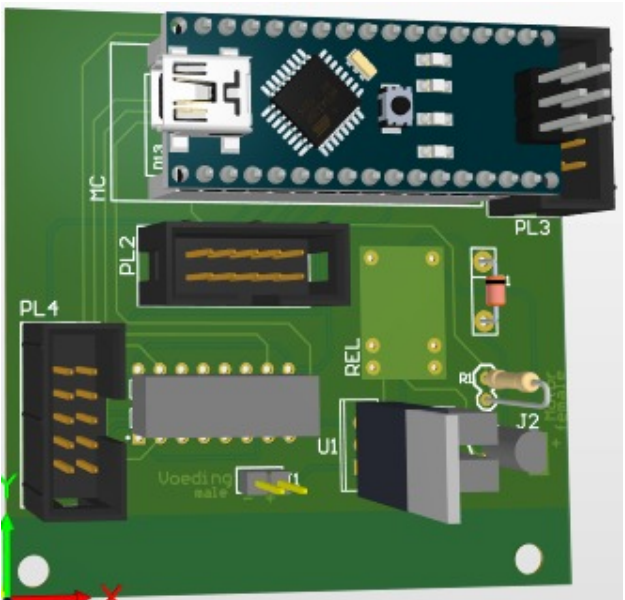

Relais:
FRS1B-S

Print afmeting: 62x76mm
 Print getekend op 2x de ware grootte

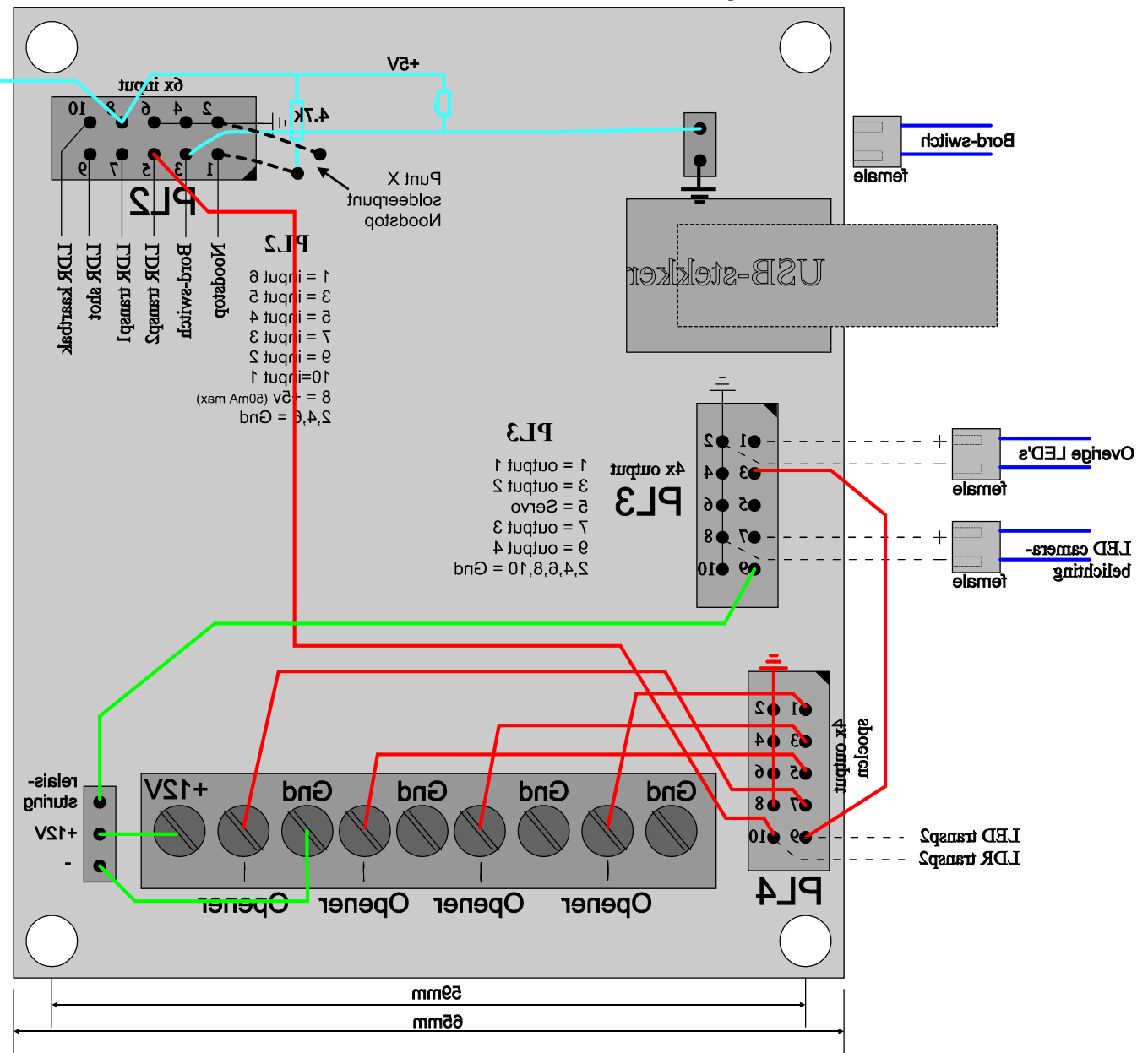

Waarstanden nietgeprobeerd.
 Elk 15k op de print solderen.

In rood, groen en blauw:
 Op de print doorverboden bedrading

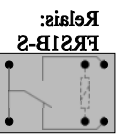
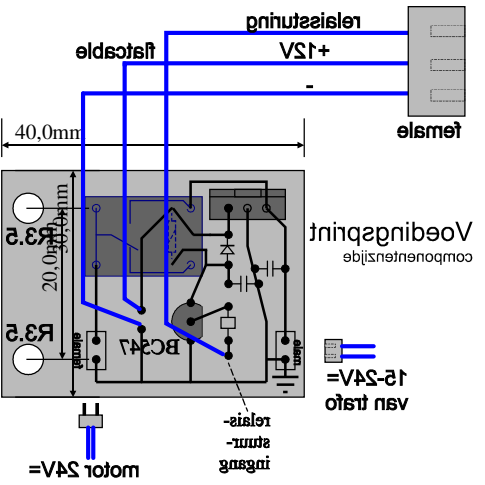

PL2 Kabels naar LDR's, bordswitch en noodstop

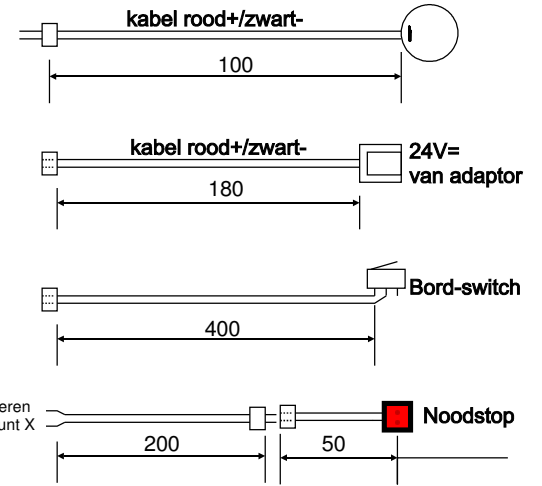
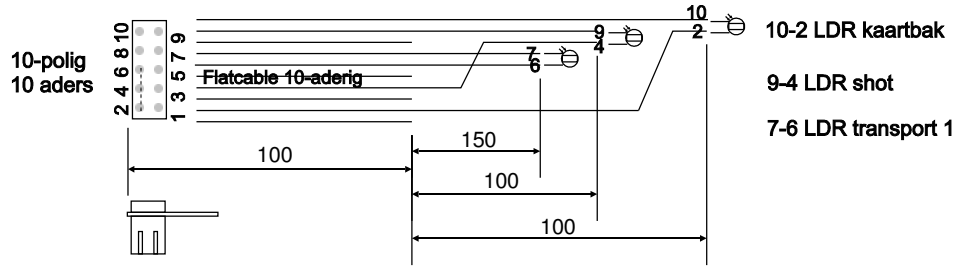

PL3 Kabels naar LED's

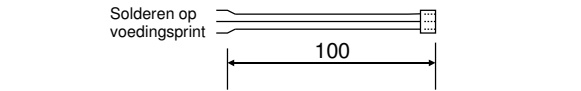
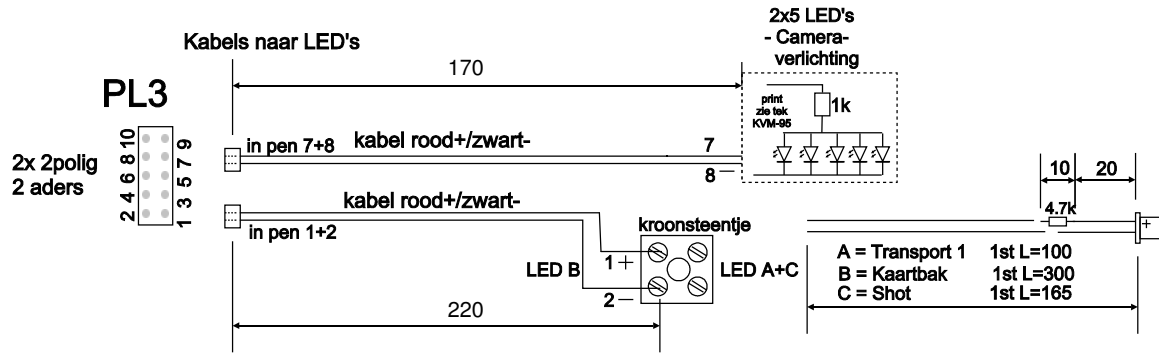

PL4 Kabelboom voor Opener's en Bandsnelheidsmeting

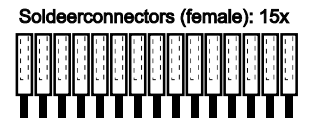
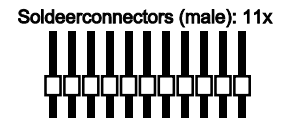
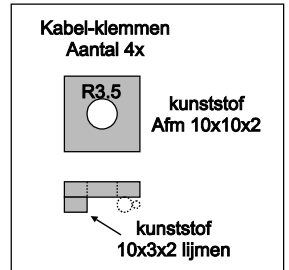
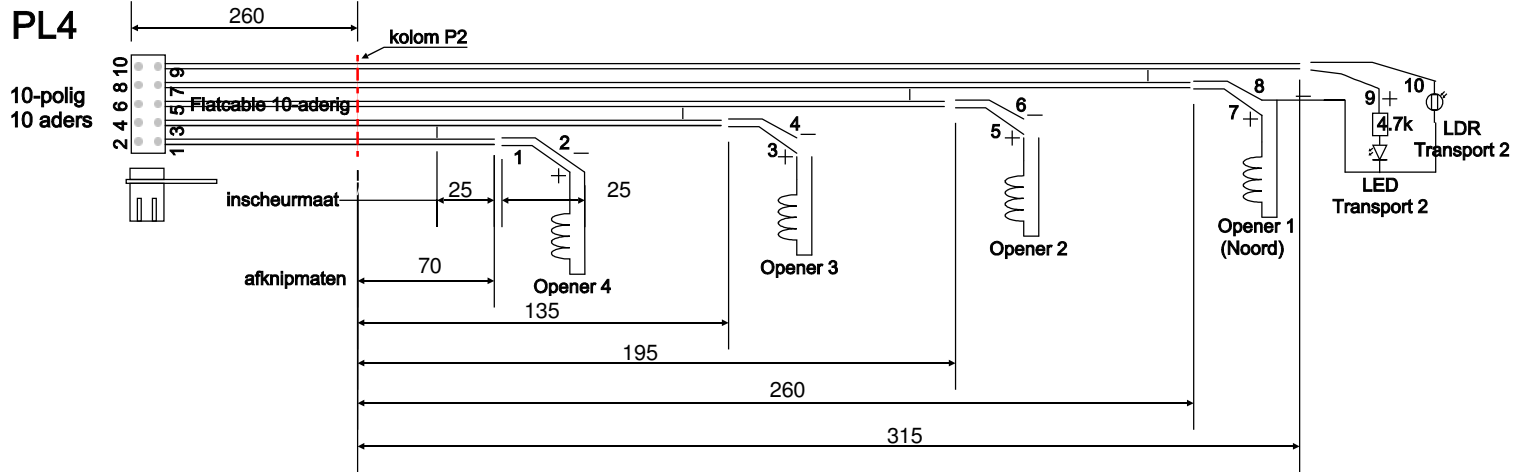

Kabels naar LDR's,

PL2

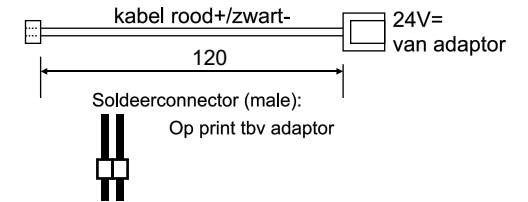
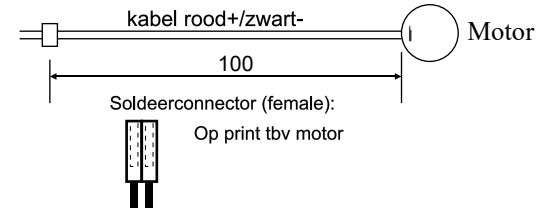
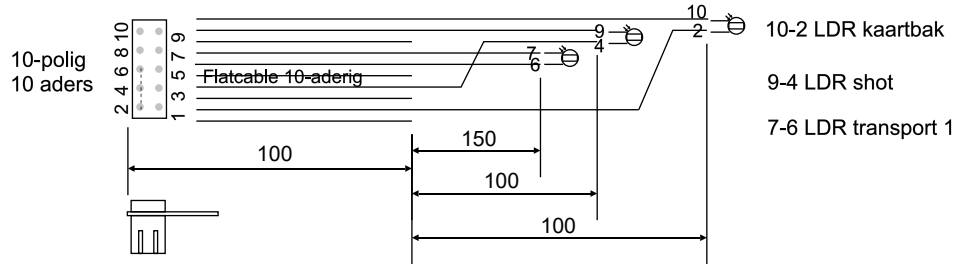

Kabels o.a. naar LED's

PL3

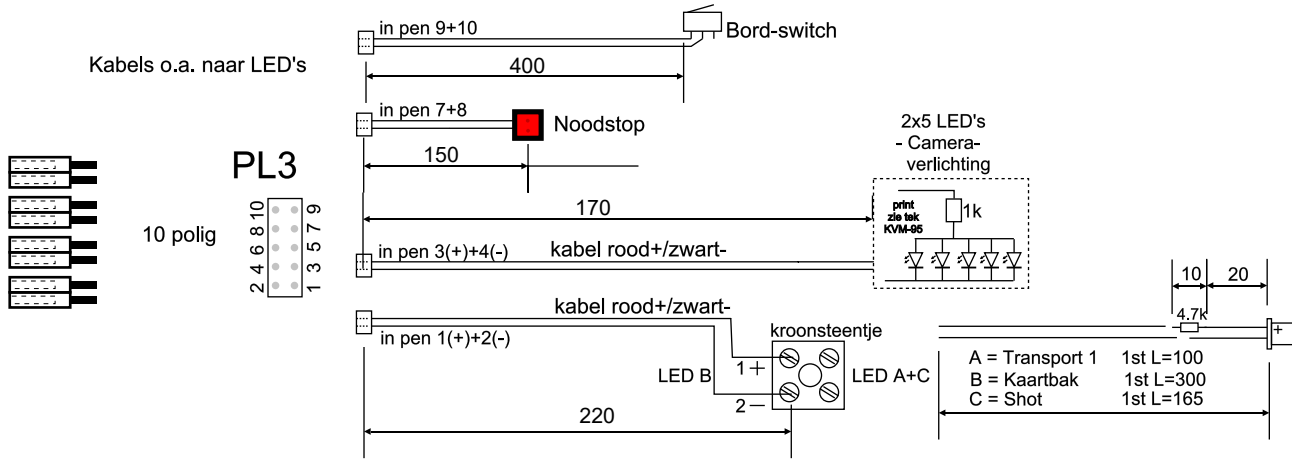

Kabelboom voor Opener's en Bandsnelheidsmeting

PL4

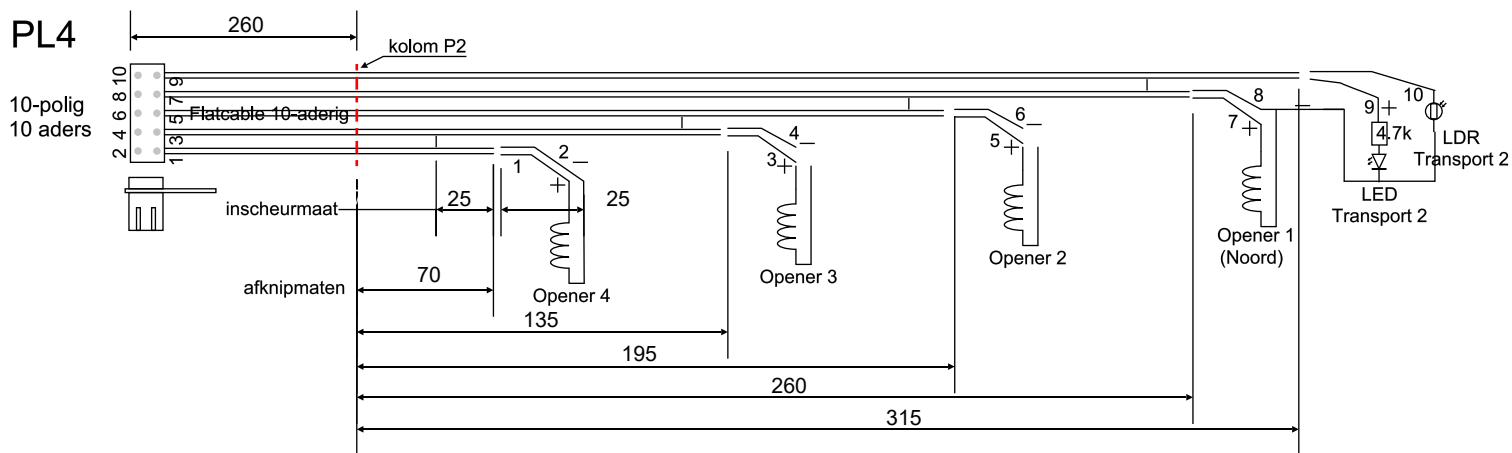

Kabel-klemmen
Aantal 4x

R3.5 kunststof
Afm 10x10x2

kunststof
10x3x2 lijmen

Soldeerzijde

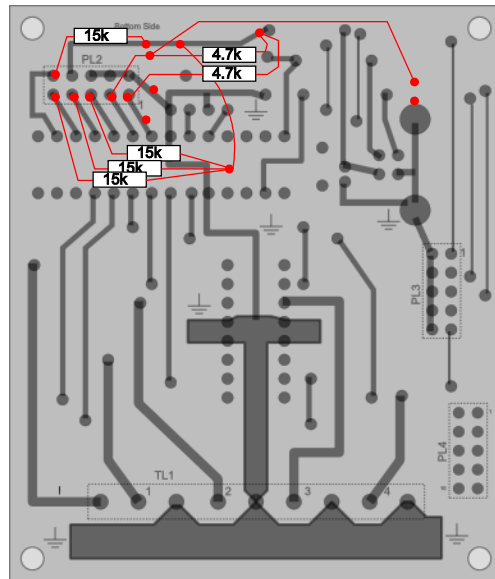

Onderdelenzijde

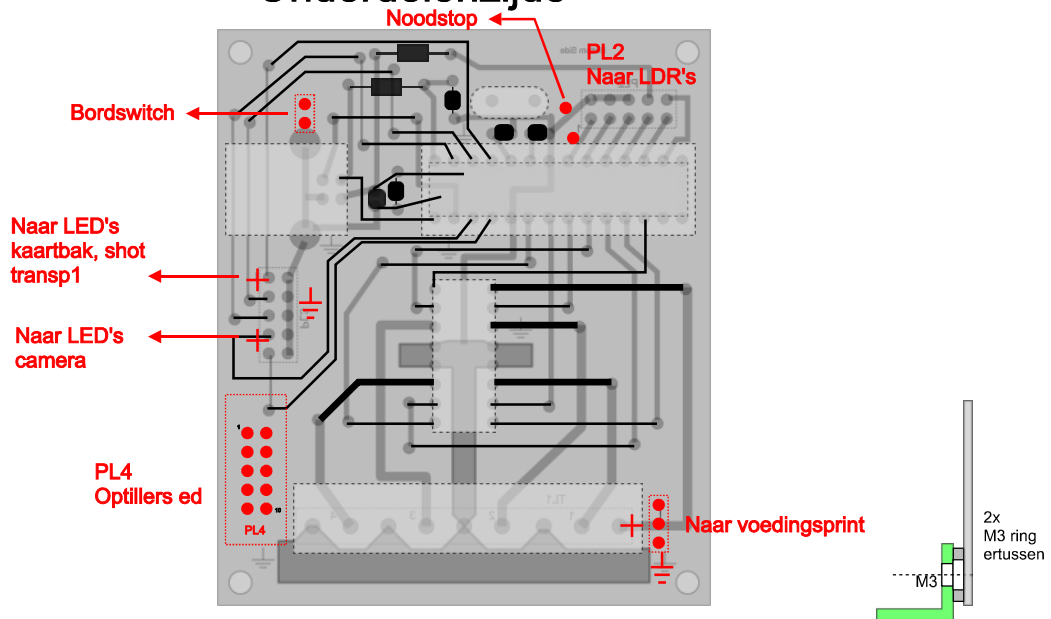

Copyright JanvdVen

USB-print-aanpassing

1-8-2009 Rev:
Teknr: KVM-94

Printplaatje tbv Led-belichting camera
afmeting 76x10mm

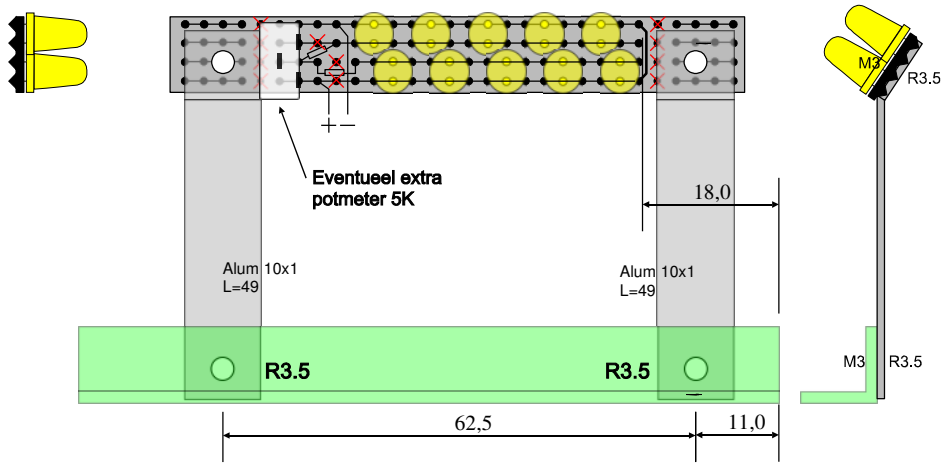

Copyright JanvdVen

Camera
belichting

1-8-2009 Rev:
Teknr: KVM-95